



TRAFFIC CRASH REPORT

*DENOTES MANDATORY FIELD FOR SUPPLEMENT REPORT

LOCAL REPORT NUMBER*

2 0 2 0 - 0 0 0 0 5 1 7 6

PHOTOS TAKEN OH-2 OH-3
 SECONDARY CRASH OH-1P OTHER
 PRIVATE PROPERTY

LOCAL INFORMATION
 REPORTING AGENCY NAME*
City of Kent Police NCIC*
0 6 7 0 3

HIT/SKIP
 1 - SOLVED NUMBER OF UNITS UNIT IN ERROR
 2 - UNSOLVED **0 1** **0 1**
 98 - ANIMAL
 99 - UNKNOWN

COUNTY* **6 7** LOCALITY* **1**
 1 - CITY
 2 - VILLAGE
 3 - TOWNSHIP
 LOCATION: CITY, VILLAGE, TOWNSHIP*
Kent

CRASH DATE / TIME*
03112020/1718 CRASH SEVERITY
2
 1 - FATAL
 2 - SERIOUS INJURY SUSPECTED
 3 - MINOR INJURY SUSPECTED
 4 - INJURY POSSIBLE
 5 - PROPERTY DAMAGE ONLY

ROUTE TYPE ROUTE NUMBER PREFIX LOCATION ROAD NAME ROAD TYPE
 1 - NORTH
 2 - SOUTH
 3 - EAST
 4 - WEST
1 **DEPEYER** **S T**

LATITUDE DECIMAL DEGREES
41,157527

ROUTE TYPE ROUTE NUMBER PREFIX REFERENCE ROAD NAME (ROAD, MILEPOST, HOUSE #)
 1 - NORTH
 2 - SOUTH
 3 - EAST
 4 - WEST
503

LONGITUDE DECIMAL DEGREES
-81,356270

REFERENCE POINT DIRECTION FROM REFERENCE ROUTE TYPE ROAD TYPE
 1 - INTERSECTION 1 - NORTH
 2 - MILE POST 2 - SOUTH
 3 - HOUSE # 3 - EAST
 4 - WEST
3 **1**
 IR - INTERSTATE ROUTE(TP)
 US - FEDERAL US ROUTE
 SR - STATE ROUTE
 CR - NUMBERED COUNTY ROUTE
 TR - NUMBERED TOWNSHIP ROUTE
 AL - ALLEY HW - HIGHWAY RD - ROAD
 AV - AVENUE LA - LANE SQ - SQUARE
 BL - BOULEVARD MP - MILEPOST ST - STREET
 CR - CIRCLE OV - OVAL TE - TERRACE
 CT - COURT PK - PARKWAY TL - TRAIL
 DR - DRIVE PI - PIKE WA - WAY
 HE - HEIGHTS PL - PLACE

INTERSECTION RELATED
 WITHIN INTERSECTION OR ON APPROACH
 WITHIN INTERCHANGE AREA NUMBER OF APPROACHES
 ROADWAY
 ROADWAY DIVIDED

LOCATION OF FIRST HARMFUL EVENT MANNER OF CRASH COLLISION/IMPACT DIRECTION OF TRAVEL MEDIAN TYPE
 1 - ON ROADWAY 9 - CROSSOVER 1 - NOT COLLISION BETWEEN TWO MOTOR VEHICLES IN TRANSPORT 4 - REAR-TO-REAR 1 - NORTH
 2 - ON SHOULDER 10 - DRIVEWAY/ALLEY ACCESS 2 - REAR-END 5 - BACKING 2 - SOUTH
 3 - IN MEDIAN 11 - RAILWAY GRADE CROSSING 3 - HEAD-ON 6 - ANGLE 3 - EAST
 4 - ON ROADSIDE 12 - SHARED USE PATHS OR TRAILS 9 - OTHER / UNKNOWN 7 - SIDESWIPE, SAME DIRECTION 4 - WEST
 5 - ON GORE 13 - BIKE LANE 8 - SIDESWIPE, OPPOSITE DIRECTION
 6 - OUTSIDE TRAFFIC WAY 14 - TOLL BOOTH
 7 - ON RAMP 99 - OTHER / UNKNOWN
 8 - OFF RAMP

WORK ZONE RELATED WORK ZONE TYPE LOCATION OF CRASH IN WORK ZONE CONTOUR CONDITIONS SURFACE
 WORKERS PRESENT 1 - LANE CLOSURE 1 - BEFORE THE 1ST WORK ZONE WARNING SIGN 1
 LAW ENFORCEMENT PRESENT 2 - LANE SHIFT/CROSSOVER 2 - ADVANCE WARNING AREA 2 - STRAIGHT GRADE 1 - DRY 1
 ACTIVE SCHOOL ZONE 3 - WORK ON SHOULDER OR MEDIAN 3 - TRANSITION AREA 3 - CURVE LEVEL 3 - SNOW 2
 4 - INTERMITTENT OR MOVING WORK 4 - ACTIVITY AREA 4 - CURVE GRADE 4 - ICE 5 - SAND, MUD, DIRT, OIL, GRAVEL
 5 - OTHER 5 - TERMINATION AREA 9 - OTHER/UNKNOWN 5 - WATER (STANDING, MOVING)
 6 - SLAG, GRAVEL, STONE
 7 - SLUSH
 9 - OTHER/UNKNOWN

LIGHT CONDITION WEATHER
 1 - DAYLIGHT 1 - CLEAR 6 - SNOW
 2 - DAWN/DUSK 2 - CLOUDY 7 - SEVERE CROSSWINDS
 3 - DARK - LIGHTED ROADWAY 3 - FOG, SMOG, SMOKE 8 - BLOWING SAND, SOIL, DIRT, SNOW
 4 - DARK - ROADWAY NOT LIGHTED 4 - RAIN 9 - FREEZING RAIN OR FREEZING DRIZZLE
 5 - DARK - UNKNOWN ROADWAY LIGHTING 5 - SLEET, HAIL 99 - OTHER / UNKNOWN
 9 - OTHER / UNKNOWN

NARRATIVE
20-5176
3-11-20
 On this date, Unit #1 was traveling N/B in front of 503 N. Depeyster St. The driver stated that he was slowing down to turn into his driveway at 506 N. Depeyster St when he lost control of his motorcycle and fell to the right. The driver of Unit #1 stated that he must have hit a rock or something which caused him to lose control. I looked around in the area, but I did not see any rocks or other debris on

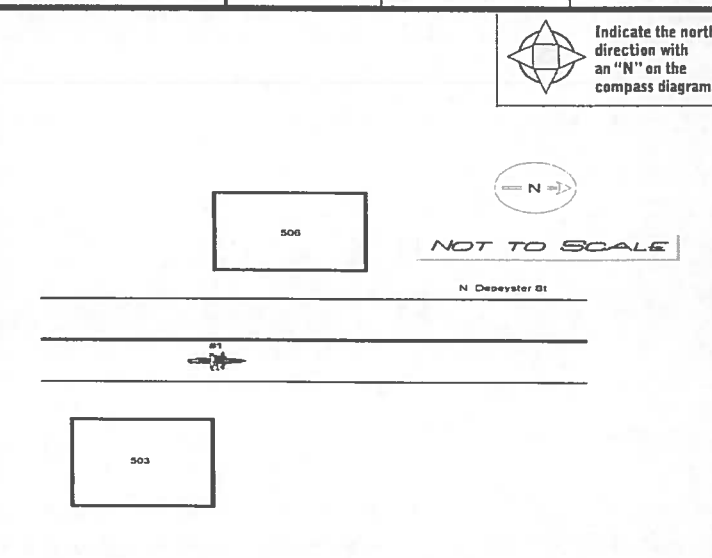

CRASH REPORTED DATE / TIME DISPATCH DATE / TIME ARRIVAL DATE / TIME SCENE CLEARED DATE / TIME REPORT TAKEN BY
03112020/1718 **03112020/1720** **03112020/1722** **03112020/1730** POLICE AGENCY
 MOTORIST
 TOTAL TIME ROADWAY CLOSED OTHER INVESTIGATION TIME TOTAL MINUTES OFFICER'S NAME* CHECKED BY OFFICER'S NAME*
0 1 0 **0 6 0** **0 7 0** **Brooks, Matthew** **Ennemoser, James**
 OFFICER'S BADGE NUMBER* CHECKED BY OFFICER'S BADGE NUMBER*
2 1 5 **2 5 5**
 SUPPLEMENT (CORRECTION OR ADDITION TO AN EXISTING REPORT SENT TO COMPS)

OWNER

UNIT # 01 OWNER NAME: LAST, FIRST, MIDDLE (X SAME AS DRIVER)
WINLAND, DAVID, MICHAEL

OWNFR PHONE: INCLUDE AREA CODE (X SAME AS DRIVER)

OWNER ADDRESS: STREET, CITY, STATE, ZIP (X SAME AS DRIVER)
506 DEPEYSTER ST, Kent, OH 44240

COMMERCIAL CARRIER: NAME, ADDRESS, CITY, STATE, ZIP

COMMERCIAL CARRIER PHONE: INCLUDE AREA CODE

VEHICLE

LP STATE OH LICENSE PLATE # 4G3468 VEHICLE IDENTIFICATION # 1HD1BNL10SY034717 VEHICLE YEAR 1995 VEHICLE MAKE Harley Davidson

INSURANCE VERIFIED INSURANCE COMPANY GEICO INSURANCE POLICY # 6017975548 COLOR BLK VEHICLE MODEL FLSTN

TYPE OF USE: COMMERCIAL GOVERNMENT IN EMERGENCY RESPONSE

US DOT # _____ TOWED BY: COMPANY NAME _____

HAZARDOUS MATERIAL: MATERIAL RELEASED CLASS # _____ PLACARD ID # _____ PLACARD

UNIT TYPE: 07

OF TRAILING UNITS: 0

1 - PASSENGER CAR 7 - MOTORCYCLE 2-WHEELED 12 - GOLF CART 18 - LIMO (LIVERY VEHICLE) 23 - PEDESTRIAN / SKATER
 2 - PASSENGER VAN (MINIVAN) 8 - MOTORCYCLE 3-WHEELED 13 - SNOWMOBILE 19 - BUS (16+ PASSENGERS) 24 - WHEELCHAIR (ANY TYPE)
 3 - SPORT UTILITY VEHICLE 9 - AUTOCYCLE 14 - SINGLE UNIT TRUCK 20 - OTHER VEHICLE 25 - OTHER NON-MOTORIST
 4 - PICK UP 10 - MOPED OR MOTORIZED BICYCLE 15 - SEMI-TRACTOR 21 - HEAVY EQUIPMENT 26 - BICYCLE
 5 - CARGO VAN 11 - ALL TERRAIN VEHICLE (ATV / UTV) 16 - FARM EQUIPMENT 22 - ANIMAL WITH RIDER OR ANIMAL-DRAWN VEHICLE 27 - TRAIN
 6 - VAN (9-15 SEATS) 17 - MOTORHOME 99 - UNKNOWN OR HITSKIP

WAS VEHICLE OPERATING IN AUTONOMOUS MODE WHEN CRASH OCCURRED? 2

1 - YES 2 - NO 9 - OTHER / UNKNOWN

AUTONOMOUS MODE LEVEL: 0

0 - NO AUTOMATION 1 - DRIVER ASSISTANCE 2 - PARTIAL AUTOMATION 3 - CONDITIONAL AUTOMATION 4 - HIGH AUTOMATION 5 - FULL AUTOMATION 9 - UNKNOWN

SPECIAL FUNCTION: 01

1 - NONE 2 - TAXI 3 - ELECTRONIC RIDE SHARING 4 - SCHOOL TRANSPORT 5 - BUS - TRANSIT/COMMUTER 6 - BUS - CHARTER/TOUR 7 - BUS - INTERCITY 8 - BUS - SHUTTLE 9 - BUS - OTHER 10 - AMBULANCE 11 - FIRE 12 - MILITARY 13 - POLICE 14 - PUBLIC UTILITY 15 - CONSTRUCTION EQUIPMENT 16 - FARM 17 - MOWING 18 - SNOW REMOVAL 19 - TOWING 20 - SAFETY SERVICE PATROL 21 - MAIL CARRIER 99 - OTHER / UNKNOWN

CARGO BODY TYPE: 01

1 - NO CARGO BODY TYPE / NOT APPLICABLE 2 - BUS 3 - VEHICLE TOWING ANOTHER MOTOR VEHICLE 4 - LOGGING 5 - INTERMODAL CONTAINER CHASSIS 6 - CARGO VAN/ENCLOSED BOX 7 - GRAIN/CHIPS/GRAVEL 8 - POLE 9 - CARGO TANK 10 - FLAT BED 11 - DUMP 12 - CONCRETE MIXER 13 - AUTO TRANSPORTER 14 - GARBAGE/REFUSE 99 - OTHER / UNKNOWN

VEHICLE DEFECTS: _____

1 - TURN SIGNALS 2 - HEAD LAMPS 3 - TAIL LAMPS 4 - BRAKES 5 - STEERING 6 - TIRE BLOWOUT 7 - WORN OR SLICK TIRES 8 - TRAILER EQUIPMENT DEFECTIVE 9 - MOTOR TROUBLE 10 - DISABLED FROM PRIOR ACCIDENT 99 - OTHER / UNKNOWN

NON-MOTORIST LOCATION AT IMPACT: _____

1 - INTERSECTION - MARKED CROSSWALK 2 - INTERSECTION - UNMARKED CROSSWALK 3 - INTERSECTION - OTHER CROSSWALK 5 - TRAVEL LANE - OTHER LOCATION 6 - BICYCLE LANE 7 - SHOULDER / ROADSIDE 8 - SIDEWALK 9 - MEDIAN/CROSSING ISLAND 10 - DRIVEWAY ACCESS 11 - SHARED USE PATHS OR TRAILS 12 - FIRST RESPONDER AT INCIDENT SCENE 99 - OTHER / UNKNOWN

ACTION: 2

1 - NON-CONTACT 2 - NON-COLLISION 3 - STRIKING 4 - STRUCK 5 - BOTH STRIKING & STRUCK 9 - OTHER / UNKNOWN

1 - STRAIGHT AHEAD 2 - BACKING 3 - CHANGING LANES 4 - OVERTAKING/PASSING 5 - MAKING RIGHT TURN 6 - MAKING LEFT TURN

7 - MAKING U-TURN 8 - ENTERING TRAFFIC LANE 9 - LEAVING TRAFFIC LANE 10 - PARKED 11 - SLOWING OR STOPPED IN TRAFFIC 12 - DRIVERLESS

13 - NEGOTIATING A CURVE 14 - ENTERING OR CROSSING SPECIFIED LOCATION 15 - WALKING, RUNNING, JOGGING, PLAYING 16 - WORKING 17 - PUSHING VEHICLE

18 - APPROACHING OR LEAVING VEHICLE 19 - STANDING 20 - OTHER NON-MOTORIST 21 - STANDING OUTSIDE DISABLED VEHICLE 99 - OTHER / UNKNOWN

CONTRIBUTING CIRCUMSTANCES: 99

1 - NONE 2 - FAILURE TO YIELD 3 - RAN RED LIGHT 4 - RAN STOP SIGN 5 - UNSAFE SPEED 6 - IMPROPER TURN 7 - LEFT OF CENTER 8 - FOLLOWING TOO CLOSE / ACDA 9 - IMPROPER LANE CHANGE 10 - IMPROPER PASSING 11 - DROVE OFF ROAD 12 - IMPROPER BACKING 13 - IMPROPER START FROM A PARKED POSITION 14 - STOPPED OR PARKED ILLEGALLY 15 - SWERVING TO AVOID 16 - WRONG WAY 17 - VISION OBSTRUCTION 18 - OPERATING DEFECTIVE EQUIPMENT 19 - LOAD SHIFTING/FALLING/SPILLING 20 - IMPROPER CROSSING 21 - LYING IN ROADWAY 22 - NOT DISCERNIBLE 23 - OPENING DOOR INTO ROADWAY 99 - OTHER IMPROPER ACTION

SEQUENCE OF EVENTS: _____

EVENTS: 13

1 - OVERTURN/ROLLOVER 2 - FIRE/EXP. OSION 3 - IMMERSION 4 - JACKKNIFE 5 - CARGO / EQUIPMENT LOSS OR SHIFT 6 - EQUIPMENT FAILURE 7 - SEPARATION OF UNITS 8 - RAN OFF ROAD RIGHT 9 - RAN OFF ROAD LEFT 10 - CROSS MEDIAN 11 - CROSS CENTERLINE - OPPOSITE DIRECTION OF TRAVEL 12 - DOWNHILL RUNAWAY 13 - OTHER NON-COLLISION 14 - PEDESTRIAN 15 - PEDALCYCLE 16 - RAILWAY VEHICLE 17 - ANIMAL - FARM 18 - ANIMAL - DEER 19 - ANIMAL - OTHER 20 - MOTOR VEHICLE IN TRANSPORT 21 - PARKED MOTOR VEHICLE 22 - WORK ZONE MAINTENANCE EQUIPMENT 23 - STRUCK BY FALLING, SHIFTING CARGO OR ANYTHING SET IN MOTION BY A MOTOR VEHICLE 24 - OTHER MOVABLE OBJECT

COLLISION WITH FIXED OBJECT - STRUCK

25 - IMPACT ATTENUATOR / CRASH CUSHION 26 - BRIDGE OVERHEAD STRUCTURE 27 - BRIDGE PIER OR ABUTMENT 28 - BRIDGE PARAPET 29 - BRIDGE RAIL 30 - GUARDRAIL FACE 31 - GUARDRAIL END 32 - PORTABLE BARRIER 33 - MEDIAN CABLE BARRIER 34 - MEDIAN GUARDRAIL BARRIER 35 - MEDIAN CONCRETE BARRIER 36 - MEDIAN OTHER BARRIER 37 - TRAFFIC SIGN POST 38 - OVERHEAD SIGN POST 39 - LIGHT / LUMINARIES SUPPORT 40 - UTILITY POLE 41 - OTHER POST, POLE OR SUPPORT 42 - CULVERT 43 - CURB 44 - DITCH 45 - EMBANKMENT 46 - FENCE 47 - MAILBOX 48 - TREE 49 - FIRE HYDRANT 50 - WORK ZONE MAINTENANCE EQUIPMENT 51 - WALL 52 - BUILDING 53 - TUNNEL 54 - OTHER FIXED OBJECT 99 - OTHER / UNKNOWN

FIRST HARMFUL EVENT: 1 MOST HARMFUL EVENT: 1

DAMAGE

DAMAGE SCALE: 4

1 - NONE 2 - MINOR DAMAGE 3 - FUNCTIONAL DAMAGE 4 - DISABLING DAMAGE 9 - UNKNOWN

DAMAGED AREA(S) INDICATE ALL THAT APPLY

NO DAMAGE [0] UNDERCARRIAGE [14]
 TOP [13] ALL AREAS [15]
 UNIT NOT AT SCENE [16]

INITIAL POINT OF CONTACT: 03

0 - NO DAMAGE 13 - TOP 14 - UNDERCARRIAGE 15 - VEHICLE NOT AT SCENE 99 - UNKNOWN

TRAFFIC

TRAFFICWAY FLOW: 2

1 - ONE-WAY 2 - TWO-WAY

TRAFFIC CONTROL: 6

1 - ROUNDABOUT 2 - SIGNAL 3 - FLASHER 4 - STOP SIGN 5 - YIELD SIGN 6 - NO CONTROL

OF THROUGH LANES ON ROAD: 2

RAIL GRADE CROSSING: 1

1 - NOT INVOLVED 2 - INVOLVED-ACTIVE CROSSING 3 - INVOLVED-PASSIVE CROSSING

UNIT / NON-MOTORIST DIRECTION

FROM: 2 TO: 1

1 - NORTH 2 - SOUTH 3 - EAST 4 - WEST 5 - NORTHEAST 6 - NORTHWEST 7 - SOUTHEAST 8 - SOUTHWEST 9 - OTHER / UNKNOWN

UNIT SPEED: 015

POSTED SPEED: 25

DETECTED SPEED: 1

1 - STATED / ESTIMATED SPEED 2 - CALCULATED / EDR 3 - UNDETERMINED

MOTORIST / Non-MOTORIST

LOCAL REPORT NUMBER
2 0 2 0 - 0 0 0 0 5 1 7 6

UNIT # 0 1	NAME: LAST, FIRST, MIDDLE WINLAND, DAVID, MICHAEL				DATE OF BIRTH 0 1 3 1 1 9 7 5		AGE 4 5	GENDER M		
ADDRESS: STREET, CITY, STATE, ZIP 506 N DEPEYSTER ST ,Kent ,OH 44240					CONTACT PHONE - INCLUDE AREA CODE					
INJURIES 2	INJURED TAKEN BY 2	EMS AGENCY (NAME) Kent Fire	INJURED TAKEN TO: MEDICAL FACILITY (NAME, CITY) UHK		SAFETY EQUIPMENT USED 0 1	<input type="checkbox"/> DOT-COMPLIANT MC HELMET	SEATING POSITION 0 1	AIR BAG USAGE 5	EJECTION 2	TRAPPED 1
OL STATE O H	OPERATOR LICENSE NUMBER RL432060		OFFENSE CHARGED 333.08	LOCAL CODE <input checked="" type="checkbox"/>	OFFENSE DESCRIPTION Operation without Re			CITATION NUMBER 60734		
OL CLASS 4	ENDORSEMENT SELECT UP TO 2	RESTRICTION SELECT UP TO 3 0 3	DRIVER DISTRACTED BY 1	ALCOHOL / DRUG SUSPECTED <input type="checkbox"/> ALCOHOL <input type="checkbox"/> MARIJUANA <input type="checkbox"/> OTHER DRUG		CONDITION 1	ALCOHOL TEST STATUS TYPE VALUE STATUS TYPE RESULT SELECT UP TO 4			DRUG TEST(S) STATUS TYPE RESULT SELECT UP TO 4

UNIT #	NAME: LAST, FIRST, MIDDLE				DATE OF BIRTH		AGE	GENDER		
ADDRESS: STREET, CITY, STATE, ZIP					CONTACT PHONE - INCLUDE AREA CODE					
INJURIES	INJURED TAKEN BY	EMS AGENCY (NAME)	INJURED TAKEN TO: MEDICAL FACILITY (NAME, CITY)		SAFETY EQUIPMENT USED	<input type="checkbox"/> DOT-COMPLIANT MC HELMET	SEATING POSITION	AIR BAG USAGE	EJECTION	TRAPPED
OL STATE	OPERATOR LICENSE NUMBER		OFFENSE CHARGED	LOCAL CODE	OFFENSE DESCRIPTION			CITATION NUMBER		
OL CLASS	ENDORSEMENT SELECT UP TO 2	RESTRICTION SELECT UP TO 3	DRIVER DISTRACTED BY	ALCOHOL / DRUG SUSPECTED <input type="checkbox"/> ALCOHOL <input type="checkbox"/> MARIJUANA <input type="checkbox"/> OTHER DRUG		CONDITION	ALCOHOL TEST STATUS TYPE VALUE STATUS TYPE RESULT SELECT UP TO 4			DRUG TEST(S) STATUS TYPE RESULT SELECT UP TO 4

UNIT #	NAME: LAST, FIRST, MIDDLE				DATE OF BIRTH		AGE	GENDER		
ADDRESS: STREET, CITY, STATE, ZIP					CONTACT PHONE - INCLUDE AREA CODE					
INJURIES	INJURED TAKEN BY	EMS AGENCY (NAME)	INJURED TAKEN TO: MEDICAL FACILITY (NAME, CITY)		SAFETY EQUIPMENT USED	<input type="checkbox"/> DOT-COMPLIANT MC HELMET	SEATING POSITION	AIR BAG USAGE	EJECTION	TRAPPED
OL STATE	OPERATOR LICENSE NUMBER		OFFENSE CHARGED	LOCAL CODE	OFFENSE DESCRIPTION			CITATION NUMBER		
OL CLASS	ENDORSEMENT SELECT UP TO 2	RESTRICTION SELECT UP TO 3	DRIVER DISTRACTED BY	ALCOHOL / DRUG SUSPECTED <input type="checkbox"/> ALCOHOL <input type="checkbox"/> MARIJUANA <input type="checkbox"/> OTHER DRUG		CONDITION	ALCOHOL TEST STATUS TYPE VALUE STATUS TYPE RESULT SELECT UP TO 4			DRUG TEST(S) STATUS TYPE RESULT SELECT UP TO 4

INJURIES	SEATING POSITION	AIR BAG	OL CLASS	OL RESTRICTION(S)	DRIVER DISTRACTION	TEST STATUS
1 - FATAL	1 - FRONT - LEFT SIDE (MOTORCYCLE DRIVER)	1 - NOT DEPLOYED	1 - CLASS A	1 - ALCOHOL INTERLOCK DEVICE	1 - NOT DISTRACTED	1 - NONE GIVEN
2 - SUSPECTED SERIOUS INJURY	2 - FRONT - MIDDLE	2 - DEPLOYED FRONT	2 - CLASS B	2 - CDL INTRASTATE ONLY	2 - MANUALLY OPERATING AN ELECTRONIC COMMUNICATION DEVICE (TEXTING TYPING, DIALING)	2 - TEST REFUSED
3 - SUSPECTED MINOR INJURY	3 - FRONT - RIGHT SIDE	3 - DEPLOYED SIDE	3 - CLASS C	3 - CORRECTIVE LENSES	3 - TALKING ON HANDS-FREE COMMUNICATION DEVICE	3 - TEST GIVEN, CONTAMINATED SAMPLE / UNUSABLE
4 - POSSIBLE INJURY	4 - SECOND - LEFT SIDE (MOTORCYCLE PASSENGER)	4 - DEPLOYED BOTH FRONT / SIDE	4 - REGULAR CLASS (OHIO = D)	4 - FARM WAIVER	4 - TALKING ON HAND-HELD COMMUNICATION DEVICE	4 - TEST GIVEN, RESULTS KNOWN
5 - NO APPARENT INJURY	5 - SECOND - MIDDLE	5 - NOT APPLICABLE	5 - MC MOPED ONLY	5 - EXCEPT CLASS A BUS	5 - OTHER ACTIVITY WITH AN ELECTRONIC DEVICE	5 - TEST GIVEN, RESULTS UNKNOWN
	6 - SECOND - RIGHT SIDE	9 - DEPLOYMENT UNKNOWN	6 - NO VALID OL	6 - EXCEPT CLASS A & CLASS B BUS	7 - OTHER DISTRACTION INSIDE THE VEHICLE	
	7 - THIRD - LEFT SIDE (MOTORCYCLE SIDE CAR)			7 - EXCEPT TRACTOR-TRAILER	8 - OTHER DISTRACTION OUTSIDE THE VEHICLE	
	8 - THIRD - MIDDLE			8 - INTERMEDIATE LICENSE RESTRICTIONS	9 - OTHER / UNKNOWN	
	9 - THIRD - RIGHT SIDE			9 - LEARNER'S PERMIT RESTRICTIONS		
	10 - SLEEPER SECTION OF TRUCK CAB			10 - LIMITED TO DAYLIGHT ONLY		
	11 - PASSENGER IN OTHER ENCLOSED CARGO AREA (NON-TRAILING UNIT, BUS, PICK-UP WITH CAP)			11 - LIMITED TO EMPLOYMENT		
	12 - PASSENGER IN UNENCLOSED CARGO AREA			12 - LIMITED - OTHER		
	13 - TRAILING UNIT			13 - MECHANICAL DEVICES (SPECIAL BRAKES, HAND CONTROLS, OR OTHER ADAPTIVE DEVICES)		
	14 - RIDING ON VEHICLE EXTERIOR (NON-TRAILING UNIT)			14 - MILITARY VEHICLES ONLY		
	15 - NON-MOTORIST			15 - MOTOR VEHICLES WITHOUT AIR BRAKES		
	99 - OTHER / UNKNOWN			16 - OUTSIDE MIRROR		
				17 - PROSTHETIC AID		
				18 - OTHER		

INJURED TAKEN BY	EJECTION	TRAPPED	OL ENDORSEMENT	CONDITION	ALCOHOL TEST TYPE	DRUG TEST TYPE
1 - NOT TRANSPORTED / TREATED AT SCENE	1 - NOT EJECTED	1 - NOT TRAPPED	H - HAZMAT	1 - APPARENTLY NORMAL	1 - NONE	1 - NONE
2 - EMS	2 - PARTIALLY EJECTED	2 - EXTRICATED BY MECHANICAL MEANS	M - MOTORCYCLE	2 - PHYSICAL IMPAIRMENT	2 - BLOOD	2 - BLOOD
3 - POLICE	3 - TOTALLY EJECTED	3 - FREED BY NON-MECHANICAL MEANS	P - PASSENGER	3 - EMOTIONAL (E.G. DEPRESSED, ANGRY, DISTURBED)	3 - URINE	3 - URINE
9 - OTHER / UNKNOWN	4 - NOT APPLICABLE		N - TANKER	4 - ILLNESS	4 - BREATH	4 - BREATH
			Q - MOTOR SCOOTER	5 - FELL ASLEEP, FAINTED, FATIGUED, ETC.	5 - OTHER	5 - OTHER
			R - THREE WHEEL MOTORCYCLE	6 - UNDER THE INFLUENCE OF MEDICATIONS / DRUGS / ALCOHOL		
			S - SCHOOL BUS	9 - OTHER / UNKNOWN		
			T - DOUBLE & TRIPLE TRAILERS			
			X - TANKER / HAZMAT			

SAFETY EQUIPMENT	CONDITION	DRUG TEST RESULT(S)
1 - NONE USED	1 - APPARENTLY NORMAL	1 - AMPHETAMINES
2 - SHOULDER BELT ONLY USED	2 - PHYSICAL IMPAIRMENT	2 - BARBITURATES
3 - LAP BELT ONLY USED	3 - EMOTIONAL (E.G. DEPRESSED, ANGRY, DISTURBED)	3 - BENZODIAZEPINES
4 - SHOULDER & LAP BELT USED	4 - ILLNESS	4 - CANNABINOIDS
5 - CHILD RESTRAINT SYSTEM - FORWARD FACING	5 - FELL ASLEEP, FAINTED, FATIGUED, ETC.	5 - COCAINE
6 - CHILD RESTRAINT SYSTEM - REAR FACING	6 - UNDER THE INFLUENCE OF MEDICATIONS / DRUGS / ALCOHOL	6 - OPIATES / OPIOIDS
7 - BOOSTER SEAT	9 - OTHER / UNKNOWN	7 - OTHER
8 - HELMET USED		8 - NEGATIVE RESULTS
9 - PROTECTIVE PADS USED (ELBOW, KNEES, ETC.)		
10 - REFLECTIVE CLOTHING		
11 - LIGHTING - PEDESTRIAN / BICYCLE ONLY		
99 - OTHER / UNKNOWN		



Narrative Continuation

LOCAL REPORT NUMBER

2 0 2 0 - 0 0 0 0 5 1 7 6

the roadway. The motorcycle was picked up out of the road and pushed into the drivers driveway.

The Kent Fire/EMS were already on scene when I arrived and they had the driver of Unit #1 loaded up on a cot. The driver was then transported to University Hospital Kent where he was later issued a cite for failing to control his motorcycle and for not having a motorcycle endorsement.

Officer Brooks 215