

# Portage Hike and Bike Trail Extension along SR59

Esplanade to  
Depeyster Street  
Segment



Depeyster Street  
to Water Street  
Segment





Water Street to  
Franklin Avenue  
Segment

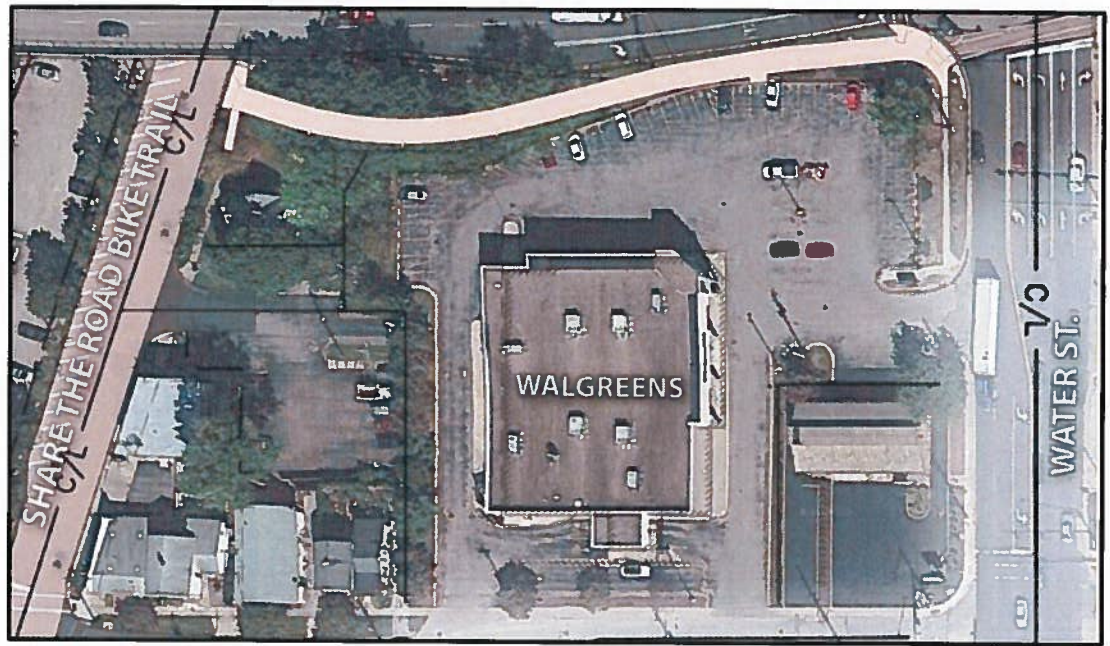

Franklin Avenue  
to Tannery Park  
Segment



CITY OF KENT  
DEPARTMENT OF PUBLIC SERVICE  
DIVISION OF ENGINEERING

MEMO

TO: Dave Ruller  
Tara Grimm

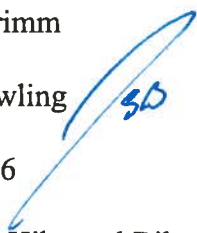
FROM: Jim Bowling 

DATE: 12/22/16

RE: Portage Hike and Bike Trail SR 59 Segment (PID 93759)  
Right-of-way Acquisition

The Engineering Division is requesting approval to purchase the required permanent and temporary right-of-way for the Portage Hike and Bike Trail SR 59 Segment Project. The property involved is located along the Haymaker Parkway at Walgreens. Walgreens has agreed to donate their portion of the fair market value (FMV), which totals \$4,450. The underlying property owner that leases the property to Walgreens has agreed to their portion of the FMV, which totals \$24,550. The FMV was determined by an Ohio Department of Transportation (ODOT) approved appraiser and reviewed by an ODOT approved review appraiser as required by our LPA Agreement with ODOT.

Attached are the following documents:

- Plat of Easement
- Legal description for permanent parcel 1-WL1
- Legal description for permanent parcel 1-WL2
- Legal description of temporary easement parcel 1-T
- OR Colan Memo summarizing the purchase

The project is funded by Parks and Recreation and a \$700,000 grant received from the Akron Metropolitan Area Transportation Study (AMATS).

We appreciate council's review of this property acquisition request.

C: John Idone  
Melanie Baker  
Bill Rudlosky, WMR Associates

**CITY OF KENT  
 COUNTY OF PORTAGE  
 STATE OF OHIO  
 PART OF BLOCK A  
 P.B. 99, PG. 96**

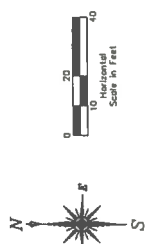

Basis of Bearing: Grid north of the Ohio  
 State Plane Coordinate System, North Zone  
 NAD83 (2011).

- LEGEND:**
- ◻ EXISTING IRON PIN
  - ◻ EXISTING MONUMENT BOX FOUND AS NOTED
  - ◻ EXISTING REBAR WITH CAP
  - ◻ EXISTING DRILL HOLE
  - ◻ 5/8" x 30" REBAR WITH CAP "DPO" SET
  - P-L- EXISTING PROPERTY LINE
  - R/W- EXISTING RIGHT OF WAY LINE
  - E-LA-R/W- EXISTING LIMITED ACCESS RIGHT OF WAY LINE
  - LA- PROPOSED LIMITED ACCESS RIGHT OF WAY LINE
  - LA-W- PROPOSED TEMPORARY RIGHT OF WAY LINE
  - P.O.B. POINT OF BEGINNING
  - T.P.O.B. TRUE POINT OF BEGINNING

REV	DATE	DESCRIPTION

**KENT - POR BIKE AND HIKE  
 SR 59 SEGMENT  
 KENT, OHIO**

**SR 59 TRAIL  
 PLAT OF EASEMENT  
 PID NO. 93759**

ISSUED FOR:	
PERMIT	
BO	
CONSTRUCTION	
RECORD	
PROJECT MANAGER	DESIGNER
SJL	TDM

2014224

1 of 1

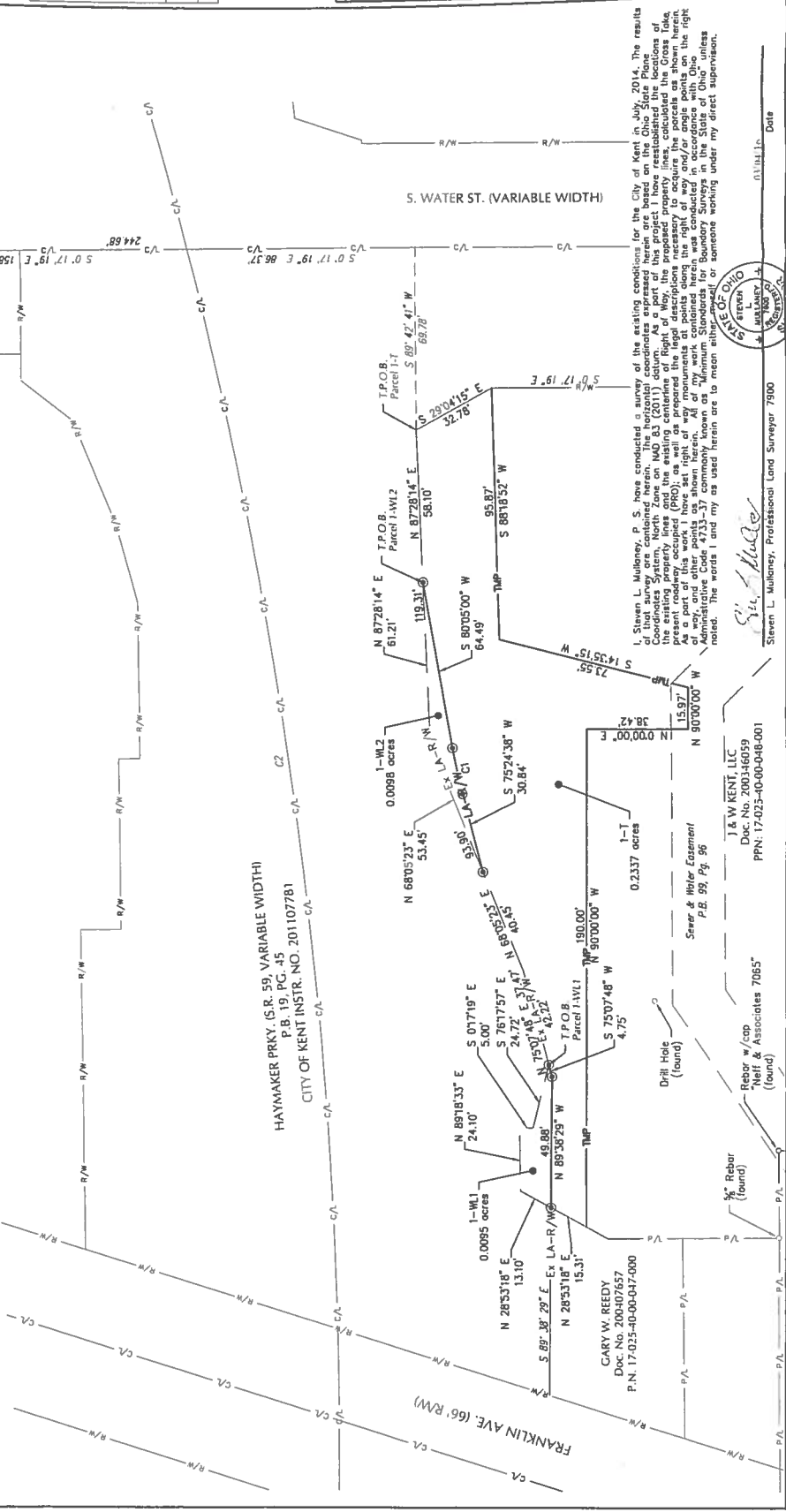

I, Steven L. Mulkeney, P. S. have conducted a survey of the existing conditions for the City of Kent in July, 2014. The results of that survey are contained herein. The horizontal coordinates entered herein are based on the Ohio State Plane Coordinates of the State of Ohio. The vertical coordinates entered herein are based on the Ohio State Plane Vertical Coordinates of the State of Ohio. The bearings and distances entered herein are based on the Ohio State Plane Coordinates of the State of Ohio. The bearings and distances entered herein are based on the Ohio State Plane Coordinates of the State of Ohio. The bearings and distances entered herein are based on the Ohio State Plane Coordinates of the State of Ohio.



Steven L. Mulkeney, Professional Land Surveyor 7900

J & W KENT, LLC  
 Doc. No. 200346059  
 PPN: 17-025-00-048-001

Steve & Myler Easement  
 P.B. 99 Pg. 96

GARY W. REEDY  
 Doc. No. 200407657  
 P.N. 17-025-00-001-000

Rebar w/cap  
 (found)

Rebar  
 (found)

Drill Hole  
 (found)

EXHIBIT A *JM*

Page 1 of 2

Rev. 06/09

LPA RX 853 WL

Ver. Date 3/4/16

PID 93759

**PARCEL 1-WL1  
KENT - POR BIKE AND HIKE  
ALL RIGHT, TITLE AND INTEREST IN FEE SIMPLE  
IN THE FOLLOWING DESCRIBED PROPERTY  
INCLUDING LIMITATION OF ACCESS  
IN THE NAME AND FOR THE USE OF THE  
CITY OF KENT, PORTAGE COUNTY, OHIO**

Grantor/Owner, his heirs, executors, administrators, successors and assigns forever, are hereby divested of any and all abutter's rights, including access rights in, over and to the within described real estate, including such rights with respect to any highway facility constructed thereon (as used herein, the expression "Grantor/Owner" includes the plural, and words in the masculine include the feminine or neuter).

[Surveyor's description of the premises follows]

Situated in the City of Kent, County of Portage, State of Ohio, and being part of Block A as shown on P.B. 99, Pg. 96 as conveyed to J & W Kent, LLC (hereinafter known as the Grantor) by Doc. No. 200346059 of said county records and being more fully described as follows:

Beginning at the intersection of the centerline of S. Water St. (variable width) with the centerline of W. College St. (80' R/W), said intersection being witnessed by a 1" Rebar in a monument box found bearing North 00 Degrees 17 Minutes 19 Seconds West, a distance of 6.11 feet; thence South 00 Degrees 17 Minutes 19 Seconds East along the centerline of said S. Water St., passing the intersection with the centerline of Haymaker Pkwy (S.R. 59) at a distance of 158.31, a total distance of 244.68 feet to a point; thence South 89 Degrees 42 Minutes 41 Seconds West, perpendicular to the centerline of said S. Water St., a distance of 69.78 feet to the intersection of the west right of way line of said S. Water St. with the south right of way line of said Haymaker Pkwy (S.R. 59), said intersection also being the Grantor's northeast corner; thence South 87 Degrees 28 Minutes 14 Seconds West along the south right of way line of said Haymaker Pkwy (S.R. 59) and the Grantor's north line, a distance of 119.31 feet to a point; thence South 68 Degrees 05 Minutes 23 Seconds West along said line, a distance of 93.90 feet to a point; thence South 75 Degrees 07 Minutes 48 Seconds West along said line, a distance of 37.47 feet to a 5/8 inch by .30 inch rebar with cap "GPD" set being the **TRUE PLACE OF BEGINNING** for the parcel hereinafter described, thence clockwise along the following six (6) courses and distances;

1. Thence South 75 Degrees 07 Minutes 48 Seconds West, a distance of 4.75 feet to a 5/8 inch by 30 inch rebar with cap "GPD" set;



**EXHIBIT A**

LPA RX 853 WL

Page 2 of 2

Rev. 06/09

2. Thence North **89 Degrees 38 Minutes 29 Seconds West**, a distance of **49.88 feet** to a 5/8 inch by 30 inch rebar with cap "GPD" set on the Grantor's west line, the northeast corner of a parcel conveyed to Gary W. Reedy (Doc. No. 200407657), and the south right of way line of said Haymaker Pkwy (S.R. 59);
3. Thence North **28 Degrees 53 Minutes 18 Seconds East** along the Grantor's west line and said south right of way line, a distance of **13.10 feet** to the Grantor's northwest corner;
4. Thence North **89 Degrees 18 Minutes 33 Seconds East** along the Grantor's north line and said south right of way line, a distance of **24.10 feet** to a point;
5. Thence South **00 Degrees 17 Minutes 19 Seconds East** along said line, a distance of **5.00 feet** to a point;
6. Thence South **76 Degrees 17 Minutes 57 Seconds East** along said line, a distance of **24.72 feet** to the **TRUE PLACE OF BEGINNING**.

The above described parcel contains 0.0095 acres, of which 0.0000 acres is in the present road occupied (P.R.O.), more or less, and subject to all easements, restrictions and covenants of record.

The above described area is contained within Portage County Parcel Number 17-025-40-00-048-001.

The Basis of Bearing is Grid North of the Ohio State Plane Coordinate System, North Zone, NAD83(2011).

This description was prepared and reviewed under the supervision of Steven L. Mullaney, Professional Surveyor No. 7900 from a survey completed in July 2014.



Glaus, Pyle, Schomer, Burns, & DeHaven, Inc.  
dba GPD Group

 03/04/16  
Steven L. Mullaney, P.S.  
Professional Surveyor No. 7900

**EXHIBIT A**

*JM*

LPA RX 853 WL

Page 1 of 2

Rev. 06/09

Ver. Date 3/4/16

PID 93759

**PARCEL 1-WL2  
KENT - POR BIKE AND HIKE  
ALL RIGHT, TITLE AND INTEREST IN FEE SIMPLE  
IN THE FOLLOWING DESCRIBED PROPERTY  
INCLUDING LIMITATION OF ACCESS  
IN THE NAME AND FOR THE USE OF THE  
CITY OF KENT, PORTAGE COUNTY, OHIO**

Grantor/Owner, his heirs, executors, administrators, successors and assigns forever, are hereby divested of any and all abutter's rights, including access rights in, over and to the within described real estate, including such rights with respect to any highway facility constructed thereon (as used herein, the expression "Grantor/Owner" includes the plural, and words in the masculine include the feminine or neuter).

[Surveyor's description of the premises follows]

Situated in the City of Kent, County of Portage, State of Ohio, and being part of Block A as shown on P.B. 99, Pg. 96 as conveyed to J & W Kent, LLC (hereinafter known as the Grantor) by Doc. No. 200346059 of said county records and being more fully described as follows:

Beginning at the intersection of the centerline of S. Water St. (variable width) with the centerline of W. College St. (80' R/W), said intersection being witnessed by a 1" Rebar in a monument box found bearing North 00 Degrees 17 Minutes 19 Seconds West, a distance of 6.11 feet; thence South 00 Degrees 17 Minutes 19 Seconds East along the centerline of said S. Water St., passing the intersection with the centerline of Haymaker Pkwy (S.R. 59) at a distance of 158.31, a total distance of 244.68 feet to a point; thence South 89 Degrees 42 Minutes 41 Seconds West, perpendicular to the centerline of said S. Water St., a distance of 69.78 feet to the intersection of the west right of way line of said S. Water St. with the south right of way line of said Haymaker Pkwy (S.R. 59), said intersection also being the Grantor's northeast corner; thence South 87 Degrees 28 Minutes 14 Seconds West along the south right of way line of said Haymaker Pkwy (S.R. 59) and the Grantor's north line, a distance of 58.10 feet to a 5/8 inch by 30 inch rebar with cap "GPD" set being the **TRUE PLACE OF BEGINNING** for the parcel hereinafter described, thence clockwise along the following five (5) courses and distances;

1. Thence **South 80 Degrees 05 Minutes 00 Seconds West**, a distance of **64.49 feet** to a 5/8 inch by 30 inch rebar with cap "GPD" set at a point of curvature;
2. Thence along a tangential curve to the left having a radius of **218.00 feet**, a central angle of **04 Degrees 40 Minutes 22 Seconds**, a chord bearing **South 77 Degrees 44 Minutes**

**EXHIBIT A**

LPA RX 853 WL

Page 2 of 2

Rev. 06/09

- 49 Seconds West, a chord distance of 17.77 feet, an arc length of 17.78 feet to a 5/8 inch by 30 inch rebar with cap "GPD" set at a point of tangency;
3. Thence South 75 Degrees 24 Minutes 38 Seconds West, a distance of 30.84 feet to a 5/8 inch by 30 inch rebar with cap "GPD" set on the south right of way line of said Haymaker Pkwy (S.R. 59) and the Grantor's north line;
  4. Thence North 68 Degrees 05 Minutes 23 Seconds East along said line, a distance of 53.45 feet to a point;
  5. Thence North 87 Degrees 28 Minutes 14 Seconds East along said line, a distance of 61.21 feet to the TRUE PLACE OF BEGINNING.

The above described parcel contains 0.0098 acres, of which 0.0000 acres is in the present road occupied (P.R.O.), more or less, and subject to all easements, restrictions and covenants of record.

The above described area is contained within Portage County Parcel Number 17-025-40-00-048-001.

The Basis of Bearing is Grid North of the Ohio State Plane Coordinate System, North Zone, NAD83(2011).

This description was prepared and reviewed under the supervision of Steven L. Mullaney, Professional Surveyor No. 7900 from a survey completed in July 2014.

Glaus, Pyle, Schomer, Burns, & DeHaven, Inc.  
dba GPD Group

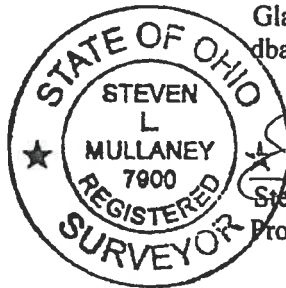

Steven L. Mullaney, P.S.  
Professional Surveyor No. 7900

03/04/16



**EXHIBIT A**

LPA RX 887 T

Page 1 of 3

Rev. 07/09

Ver. Date 3/4/16

PID 93759

**PARCEL 1-T  
KENT - POR BIKE AND HIKE  
TEMPORARY EASEMENT FOR THE PURPOSE OF  
PERFORMING THE WORK NECESSARY TO  
CONSTRUCT BIKE AND HIKE PATH  
FOR 12 MONTHS FROM DATE OF ENTRY BY THE  
CITY OF KENT, PORTAGE COUNTY, OHIO**

**[Surveyor's description of the premises follows]**

---

Situated in the City of Kent, County of Portage, State of Ohio, and being part of Block A as shown on P.B. 99, Pg. 96 as conveyed to J & W Kent, LLC (hereinafter known as the Grantor) by Doc. No. 200346059 of said county records and being more fully described as follows:

Beginning at the intersection of the centerline of S. Water St. (variable width) with the centerline of W. College St. (80' R/W), said intersection being witnessed by a 1" Rebar in a monument box found bearing North 00 Degrees 17 Minutes 19 Seconds West, a distance of 6.11 feet; thence South 00 Degrees 17 Minutes 19 Seconds East along the centerline of said S. Water St., passing the intersection with the centerline of Haymaker Pkwy (S.R. 59) at a distance of 158.31, a total distance of 244.68 feet to a point; thence South 89 Degrees 42 Minutes 41 Seconds West, perpendicular to the centerline of said S. Water St., a distance of 69.78 feet to the intersection of the west right of way line of said S. Water St. with the south right of way line of said Haymaker Pkwy (S.R. 59), said intersection also being the Grantor's northeast corner and the **TRUE PLACE OF BEGINNING** for the parcel hereinafter described, thence clockwise along the following fourteen (14) courses and distances;

1. Thence **South 29 Degrees 04 Minutes 15 Seconds East** along the west right of way line of S. Water St. and the Grantor's east line, a distance of **32.78 feet** to a point;
2. Thence **South 88 Degrees 18 Minutes 52 Seconds West**, a distance of **95.87 feet** to a point;
3. Thence **South 14 Degrees 35 Minutes 15 Seconds West**, a distance of **73.55 feet** to a point;
4. Thence **North 90 Degrees 00 Minutes 00 Seconds West**, a distance of **15.97 feet** to a point;

**EXHIBIT A**

LPA RX 887 T

Page 2 of 3

Rev. 07/09

5. Thence **North 00 Degrees 00 Minutes 00 Seconds East**, a distance of **38.42 feet** to a point;
6. Thence **North 90 Degrees 00 Minutes 00 Seconds West**, a distance of **190.00 feet** to a point on the Grantor's west line and the east line of a parcel conveyed to Gary W. Reedy (Doc. No. 200407657);
7. Thence **North 28 Degrees 53 Minutes 18 Seconds East** along said line, a distance of **15.31 feet** to a 5/8 inch by 30 inch rebar with cap "GPD" set at the northeast corner of said Reedy parcel and on the south right of way line of said Haymaker Pkwy (S.R. 59);
8. Thence **South 89 Degrees 38 Minutes 29 Seconds East**, a distance of **49.88 feet** to a 5/8 inch by 30 inch rebar with cap "GPD" set;
9. Thence **North 75 Degrees 07 Minutes 48 Seconds East** partially along the Grantor's north line and the south right of way line of said Haymaker Pkwy (S.R. 59), passing over a 5/8 inch by 30 inch rebar with cap "GPD" set at a distance of 4.75 feet, a total distance of **42.22 feet** to a point;
10. Thence **North 68 Degrees 05 Minutes 23 Seconds East** along said line, a distance of **40.45 feet** to a 5/8 inch by 30 inch rebar with cap "GPD" set;
11. Thence **North 75 Degrees 24 Minutes 38 Seconds East**, a distance of **30.84 feet** to a 5/8 inch by 30 inch rebar with cap "GPD" set at a point of curvature;
12. Thence along a tangential curve to the right having a radius of **218.00 feet**, a central angle of **04 Degrees 40 Minutes 22 Seconds**, a chord bearing **North 77 Degrees 44 Minutes 49 Seconds East**, a chord distance of **17.77 feet**, an arc length of **17.78 feet** to a 5/8 inch by 30 inch rebar with cap "GPD" set at a point of tangency;
13. Thence **North 80 Degrees 05 Minutes 00 Seconds East**, a distance of **64.49 feet** to a 5/8 inch by 30 inch rebar with cap "GPD" set on the Grantor's north line and the south right of way line of said Haymaker Pkwy (S.R. 59);
14. Thence **North 87 Degrees 28 Minutes 14 Seconds East** along said line, a distance of **58.10 feet** to the **TRUE PLACE OF BEGINNING**.

The above described parcel contains 0.2337 acres, of which 0.0000 acres is in the present road occupied (P.R.O.), more or less, and subject to all easements, restrictions and covenants of record.

**EXHIBIT A**

LPA RX 887 T

Page 3 of 3

Rev. 07/09

The above described area is contained within Portage County Parcel Number 17-025-40-00-048-001.

The Basis of Bearing is Grid North of the Ohio State Plane Coordinate System, North Zone, NAD83(2011).

This description was prepared and reviewed under the supervision of Steven L. Mullaney, Professional Surveyor No. 7900 from a survey completed in July 2014.

Glaus, Pyle, Schomer, Burns, & DeHaven, Inc.  
dba GPD Group

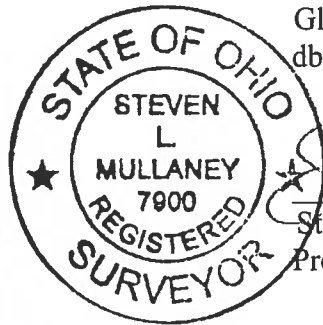

*Steven L. Mullaney* 03/04/16  
Steven L. Mullaney, P.S.  
Professional Surveyor No. 7900



Closure Report  
Parcel 1-T

Segment #1 : Line

Course: S 29° 04' 15" E Length: 32.78'  
North: 542803.72902607' East: 2282873.75587775'

Segment #2 : Line

Course: S 88° 18' 52" W Length: 95.87'  
North: 542800.90908183' East: 2282777.92736000'

Segment #3 : Line

Course: S 14° 35' 15" W Length: 73.55'  
North: 542729.73002930' East: 2282759.40318712'

Segment #4 : Line

Course: N 90° 00' 00" W Length: 15.97'  
North: 542729.73002930' East: 2282743.43318712'

Segment #5 : Line

Course: N 0° 00' 00" E Length: 38.42'  
North: 542768.15002930' East: 2282743.43318712'

Segment #6 : Line

Course: N 90° 00' 00" W Length: 190.00'  
North: 542768.15002930' East: 2282553.43318712'

Segment #7 : Line

Course: N 28° 53' 18" E Length: 15.31'  
North: 542781.55489754' East: 2282560.82951103'

Segment #8 : Line

Course: S 89° 38' 29" E Length: 49.88'  
North: 542781.24270342' East: 2282610.70853403'

Segment #9 : Line



## MEMO

To: File

From: John Mandula, Right of Way Agent

Date: November 1, 2016

Re: POR – Bike & Hike: Parcel 1 – Payment for Temporary Easement

---

J&W Kent, LLC is the fee owner of parcel 1 (320 South Water Street Kent, OH) and is being offered \$29,000 as FMV broken down as follows: WL (Warranty Deed) - \$21,900, Site Improvements - \$2,650, T (Temporary Easement) - \$4,450. J&W Kent, LLC has a tenant onsite (Walgreen Co., an Illinois Corporation), and owner and tenant have agreed that the tenant will be compensated the monetary value for the Temporary Easement (\$4,450) as they are the ones being affected by the project. The tenant (Walgreen Co., an Illinois Corporation) has in turn, agreed to donate their portion of the compensation (\$4,450) to the City of Kent, OH. This memo to file serves as the acknowledgment of these agreements.

J & W KENT, LLC, a Delaware limited liability company

By J & W Salt Lake, LLC, its Sole Member. By: JWSL, INC., its managing member

Owner: By: Walter R. Samuels  
Walter R. Samuels, President

Date: December 19, 2016

inlet  
Tenant: Richard M. Steiner  
Richard M. Steiner  
Director

Date: 11-7-16



**Kent Parks & Recreation Department**

497 Middlebury Road Kent, Ohio 44240 (330) 673-8897 FAX: (330) 673-8898

TO: Dave Ruller, Jim Silver  
FROM: John Idone   
DATE: January 3, 2017  
RE: Kent Parks & Recreation Donation

\* M E S S A G E \*

Kent Parks & Recreation Department has received a donation of \$1,500 from Henry V. and Frances W. Christenson Charitable Foundation for beautification in Kent's parks.

The check has been forwarded to Budget and Finance and will be held until Council formally accepts the donation. Your attention to this matter is sincerely appreciated.

PC: Budget & Finance  
Tara Grimm, Clerk of Council  
Kent Parks & Recreation Board



# KENT HEALTH DEPARTMENT STATISTICAL REPORT 2016

3. A.

	Dec. 2016	YTD 2016	Dec. 2015	YTD 2015
<b>HEALTH DEPT. \$ COLLECTED</b>				
FamAbuse fund	\$ 1,026.00	\$ 13,600.57	\$ 868.52	\$ 12,687.09
Vital Stats Rev.	\$ 5,814.00	\$ 77,112.00	\$ 4,921.50	\$ 71,947.50
Child Abuse	\$ 2,052.00	\$ 27,215.43	\$ 1,736.98	\$ 25,373.91
State VS	\$ 6,156.00	\$ 81,657.00	\$ 5,211.00	\$ 76,067.50
B Perm Rev	\$ 31.50	\$ 334.50	\$ 27.50	\$ 329.00
B Perm State	\$ 157.50	\$ 1,675.00	\$ 137.50	\$ 1,645.00
Food Estab.	\$ 0.00	\$ 27,809.25	\$ 0.00	\$ 23,816.25
Food Service	\$ 578.00	\$ 78,750.75	\$ 0.00	\$ 71,110.50
SolWst Tickets	\$ 90.00	\$ 590.00	\$ 0.00	\$ 1,000.00
Housing	\$ 7,823.75	\$ 124,175.00	\$ 6,615.00	\$ 121,065.75
Swim Pools	\$ 0.00	\$ 8,102.50	\$ 0.00	\$ 6,765.00
SolWst(Trks)	\$ 0.00	\$ 2,950.00	\$ 0.00	\$ 3,100.00
Tattoo Parlors	\$ 1,200.00	\$ 2,000.00	\$ 900.00	\$ 1,950.00
*Misc(Xerox, etc.)	\$ 1.00	\$ 7,845.25	\$ 40.00	\$ 10,660.48
	\$ 0.00	\$ 15,561.50	\$ 40.00	\$ 870.00
MAC Claiming	\$ 0.00	\$ 19,645.73	\$ 0.00	\$ 31,632.13
Tobacco Grant	\$ 0.00	\$ 19,300.00	\$ 0.00	\$ 0.00
**ST Subsidy	\$ 0.00	\$ 22,882.00	\$ 0.00	\$ 25,259.00
<b>TOTAL COLLECTED</b>	<b>\$ 24,929.75</b>	<b>\$ 531,206.48</b>	<b>\$ 20,498.00</b>	<b>\$ 485,279.11</b>
<b>TO STATE</b>				
FamAbuse fund	\$ 995.23	\$ 13,192.56	\$ 842.45	\$ 12,306.48
Food Estabs	\$ 0.00	\$ 1,568.00	\$ 0.00	\$ 1,568.00
Bur.Permits	\$ 157.50	\$ 1,675.00	\$ 137.50	\$ 1,645.00
Child Abuse	\$ 1,990.43	\$ 26,398.99	\$ 1,684.87	\$ 24,612.69
State VS QTRLY	\$ 6,156.00	\$ 81,657.00	\$ 5,211.00	\$ 76,067.50
Food Service	\$ 28.00	\$ 6,844.00	\$ 0.00	\$ 4,108.00
Food Vendors*	\$ 0.00	\$ 12.00	\$ 0.00	\$ 132.00
Swim Pools	\$ 0.00	\$ 1,365.00	\$ 0.00	\$ 1,365.00
Wells	\$ 0.00	\$ 0.00	\$ 0.00	\$ 0.00
<b>TOTAL</b>	<b>\$ 9,327.16</b>	<b>\$ 132,712.55</b>	<b>\$ 7,875.82</b>	<b>\$ 121,804.67</b>
<b>TOTAL ASSETS</b>	<b>\$ 15,602.59</b>	<b>\$ 399,458.69</b>	<b>\$ 12,622.18</b>	<b>\$ 363,474.59</b>
+Admin fee to Vital Stats	\$ 92.33	\$ 1,224.55	\$ 78.16	\$ 1,142.01
-3% FamAbuse	\$ 30.77	\$ 408.01	\$ 26.05	\$ 380.61
-3% ChildAbuse	\$ 61.56	\$ 816.44	\$ 52.11	\$ 761.22

**STATISTICAL REPORT Cont.****Dec. 2016****YTD 2016****Dec. 2015****YTD 2015****PERMIT/lic.**

Food Estabs	0	50	0	58
Food Service	1	142	0	138
FS Vending	0	25	0	22
Home Sewage	0	0	0	0
Housing	15	288	20	276
Solid Waste	0	43	0	12
Swim Pools	0	18	0	19
Septic Haul.	0	0	0	0
Tattoo Parlors	4	8	3	6
Other	0	0	0	1
<b>TOTAL</b>	<b>20</b>	<b>574</b>	<b>23</b>	<b>532</b>

**MOSQ.CONT.**

Larvacide Hrs.	0.0	0.0	0.0	0.0
Adulticide Hrs.	0.0	0.0	0.0	0.0
Tot Man Hrs	0.0	256.5	0.0	461.0

**COMPLAINTS**

Received	11	105	34	204
Abated	15	96	36	194

**LEGAL.COMPL.**

Filed	0	0	0	1
Pre-trials	0	0	0	1
Trials	0	0	0	0

**COMM.DISEASE (not available)**

0	77	0	66
---	----	---	----

**IMMUNIZATIONS**

1	278	11	216
---	-----	----	-----

**BIRTH Copies issued**

230	3777	45	3248
-----	------	----	------

**DEATH Copies issued**

454	5294	297	4220
-----	------	-----	------



## KENT FIRE DEPARTMENT MONTHLY INCIDENT REPORT NOVEMBER 2016

### FIRE INCIDENT RESPONSE INFORMATION

#### Summary of Fire Incident Alarms

	CURRENT PERIOD			YEAR TO DATE		
	2016	2015	2014	2016	2015	2014
City of Kent	49	43	49	568	575	521
Kent State University	7	3	7	70	48	74
Franklin Township	10	13	17	121	116	113
Sugar Bush Knolls	0	0	0	3	2	5
Brady Lake Village	1	1	1	14	7	2
Mutual Aid Given	4	4	2	30	33	42
<b>Total Fire Incident Alarms</b>	<b>71</b>	<b>64</b>	<b>76</b>	<b>806</b>	<b>781</b>	<b>757</b>

#### Summary of Mutual Aid Received by Location

City of Kent	1	0	1	11	10	6
Kent State University	0	0	0	1	1	0
Franklin Township	0	0	0	4	3	1
Sugar Bush Knolls	0	0	0	0	0	0
Brady Lake Village	0	0	0	1	0	0
<b>Total Mutual Aid</b>	<b>1</b>	<b>0</b>	<b>1</b>	<b>17</b>	<b>14</b>	<b>7</b>

### EMERGENCY MEDICAL SERVICE RESPONSE INFORMATION

#### Summary of Emergency Medical Service Responses

	CURRENT PERIOD			YEAR TO DATE		
	2016	2015	2014	2016	2015	2014
City of Kent	177	172	208	2137	2117	2066
Kent State University	44	33	39	340	330	359
Franklin Township	45	21	40	422	354	372
Sugar Bush Knolls	0	2	0	7	11	6
Brady Lake Village	7	2	3	31	20	6
Mutual Aid Given	6	3	0	30	30	35
<b>Total Emergency Medical Service Responses</b>	<b>279</b>	<b>233</b>	<b>290</b>	<b>2967</b>	<b>2862</b>	<b>2844</b>

#### Summary of Mutual Aid Received by Location

City of Kent	3	3	3	23	28	30
Kent State University	1	0	0	6	5	8
Franklin Township	0	2	0	5	4	5
Sugar Bush Knolls	0	0	0	0	0	0
Brady Lake Village	0	0	0	3	1	0
<b>Total Mutual Aid</b>	<b>4</b>	<b>5</b>	<b>3</b>	<b>37</b>	<b>38</b>	<b>43</b>

### TOTAL FIRE AND EMERGENCY MEDICAL SERVICE RESPONSE INCIDENTS

<b>350</b>	<b>297</b>	<b>366</b>	<b>3773</b>	<b>3643</b>	<b>3601</b>
------------	------------	------------	-------------	-------------	-------------

### TOTAL ALL RESPONSES, INCLUDING MUTUAL AID

<b>355</b>	<b>302</b>	<b>370</b>	<b>3827</b>	<b>3695</b>	<b>3651</b>
------------	------------	------------	-------------	-------------	-------------



CITY OF KENT  
DEPARTMENT OF PUBLIC SERVICE  
DIVISION OF ENGINEERING

MEMO

TO: Dave Ruller

FROM: Jim Bowling

DATE: December 9, 2016

RE: Sanitary Sewer Laterals – Insurance Protection Options

In response to City Council's request for the administration to look into an insurance based option for replacement of the sanitary sewer laterals, we researched and found the following options that are available to residential homeowners who have responsibility for their sanitary service laterals.

*Dominion Products and Services, Inc. - Sewer Line Repair Program:*

This program is associated with Dominion Energy Solutions (gas company). According to their information provided for this area coverage for the repair of a sanitary service lateral is \$4.99 per month with coverage limited at \$7,500 per occurrence. Information is available at <https://www.dominionenergy.com/en/home-protection/sewer-line> or by calling 1-888-216-3718.

*Firstenergy Corp. provided by HomeServe USA – Exterior Sewer/Septic Line Protection Plan:*

This program is associated with Ohio Edison (electric company). According to their information provided for this area coverage for the repair of a sanitary service lateral is \$8.99 per month with coverage limited at \$6,000 annually. Information is available at [https://www.firstenergycorp.com/products/protect\\_your\\_home/protection-and-repair.html](https://www.firstenergycorp.com/products/protect_your_home/protection-and-repair.html) or by calling 1-888-658-3800.

*Home Insurance Companies:*

After reviewing insurance companies web sites and contacting some directly it appears that it is unlikely that a residents' insurance company will provide policy upgrades to cover sanitary sewer lateral breaks. Individual policy holders should contact their insurance agent to see if upgrades are offered by their insurance companies.

The options above do not represent all possible options available for Kent residents. For all of the above, specific terms and conditions apply and the resident considering purchasing sanitary sewer lateral repair protection should contact the agencies directly to become informed on all the terms and conditions that apply.

c: Melanie Baker  
John Osborne  
David Coffee  
Bridget Susel

---

# 2008 to 2016 Citizen Action Center Summary

---

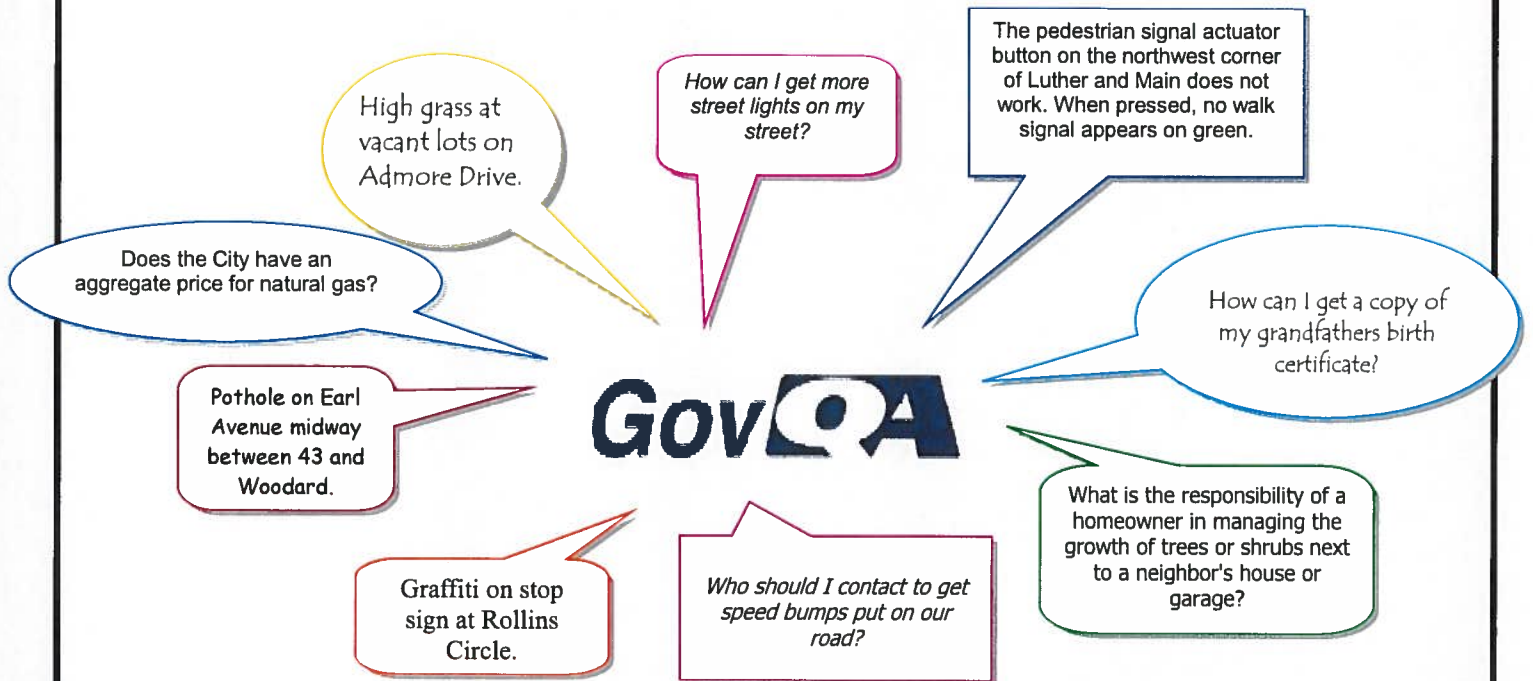

This report was prepared by staff to summarize the use of the online Citizen Action Center by Kent residents. The report includes a comparison of statistics across several years – 2008, 2009, 2010, 2011, 2012, 2013, 2014, 2015 and 2016. The Citizen Action Center went live in March 2008 so the data for 2008 is a partial year while the data for the other seven years is complete.

The Citizen Action Center allows citizens to have access to a knowledge database while also giving them the ability to communicate with City staff through the online service tools. With these tools citizens can ask staff questions, create service requests, and track the progress of their requests.

Using this data we hope to be able to continue to provide better, more convenient and effective service to citizens while saving resources.

# Online Frequently Asked Questions Use: 2008-2016

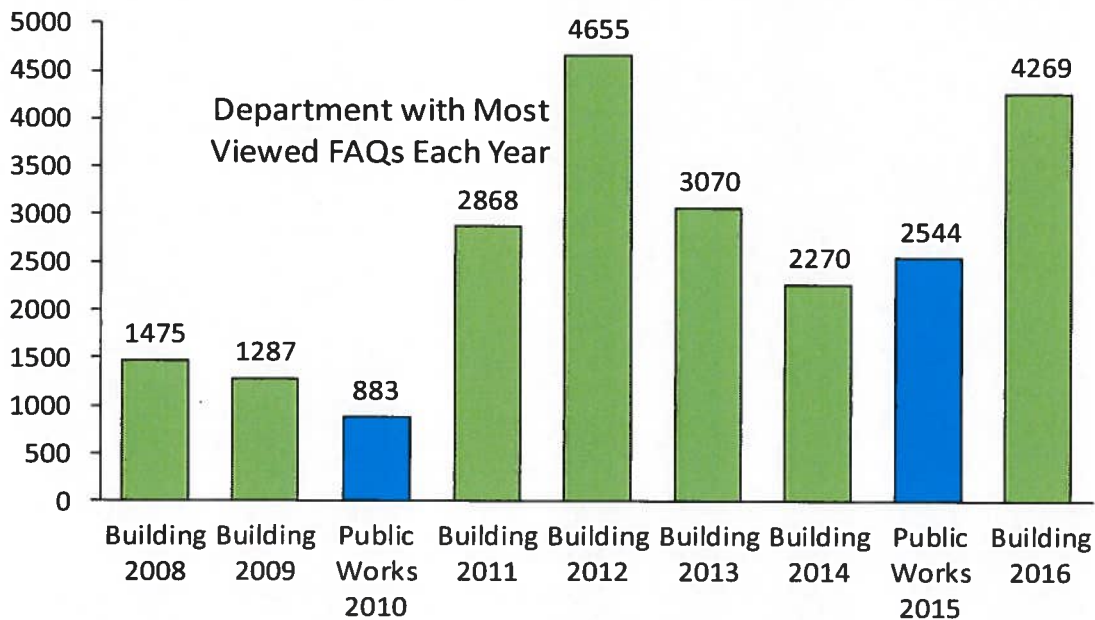
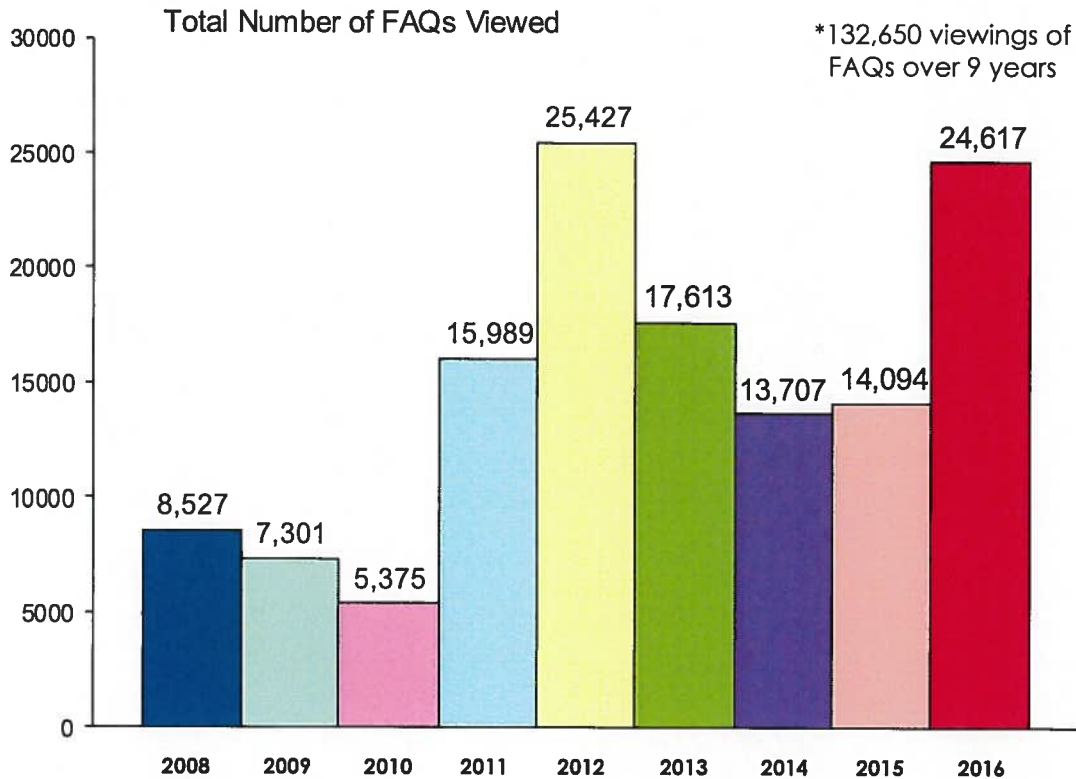

## 2008-2016 FAQ Summary

*Citizens are able to search questions using phrases or keywords*

*This allows the City's most popular information to be available online for 24/7 access*

*There are 41 total FAQs in the system*

*The top FAQ for the first three years was "Can I have a fire in my backyard?"*

*The top FAQ the last five years has been "Does the City provide public garbage pick-up?"*

*The total number of FAQ views is 132,650*

*The top searched phrases in 2016 were "employment", "zoning", and "parking"*

# Citizen Online Service Questions Use: 2008-2016

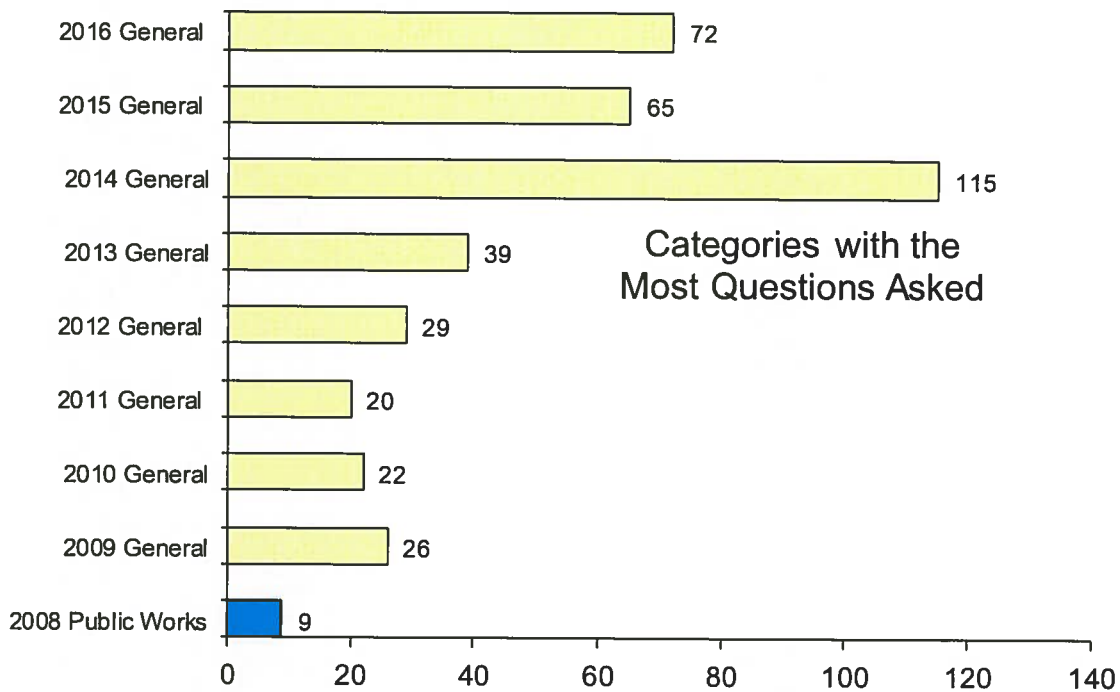
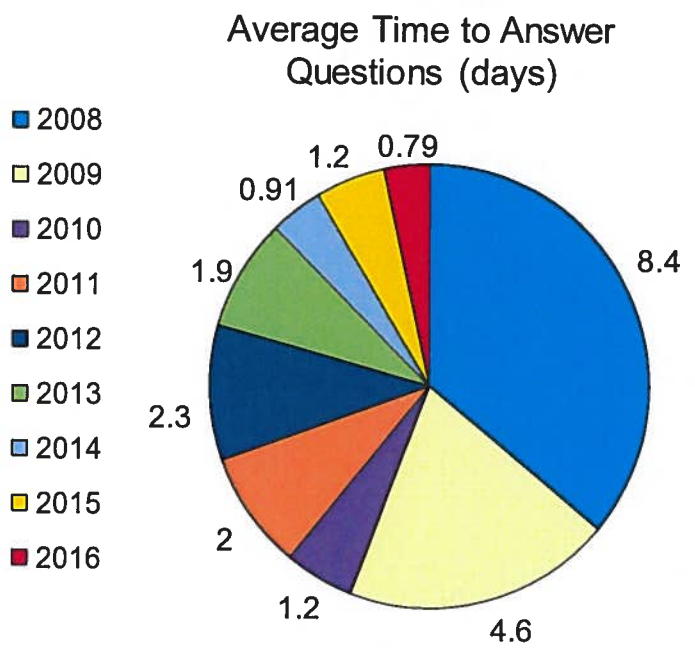
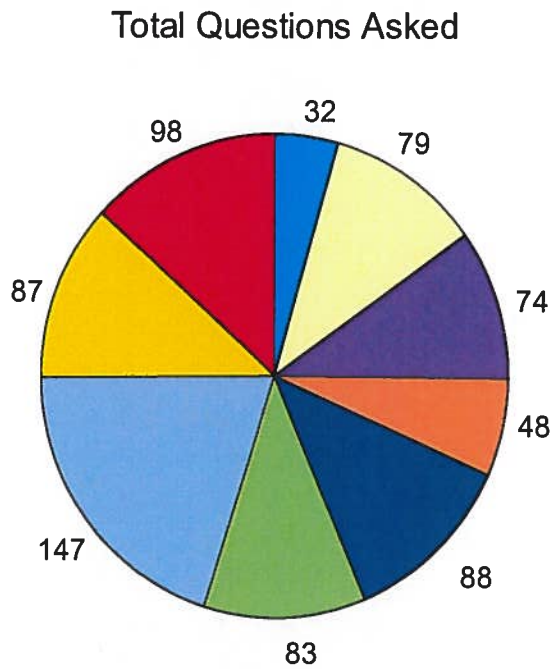

## 2008-2016 Service Question Summary

*Citizens are able to submit unique questions online*

*Questions are answered directly by the appropriate staff*

*There have been a total of 736 questions asked over 9 years*

*General types of questions have been the most popular with 384 total over the last 9 years*

# Citizen Online Service Requests 2008-2016

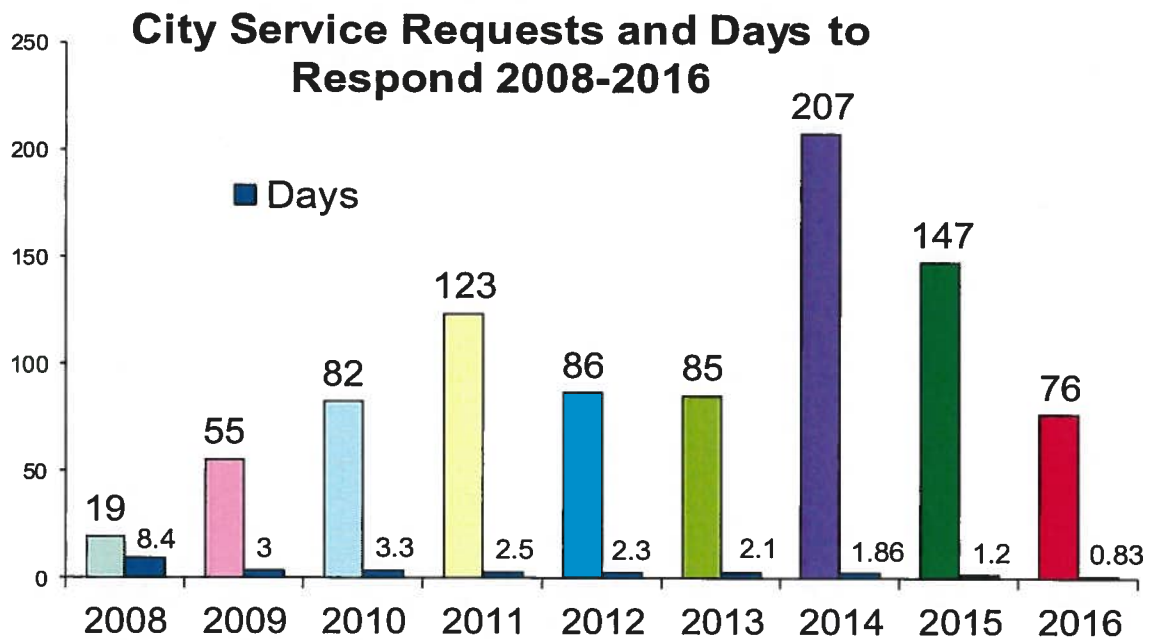

### Most Common Requests by Type

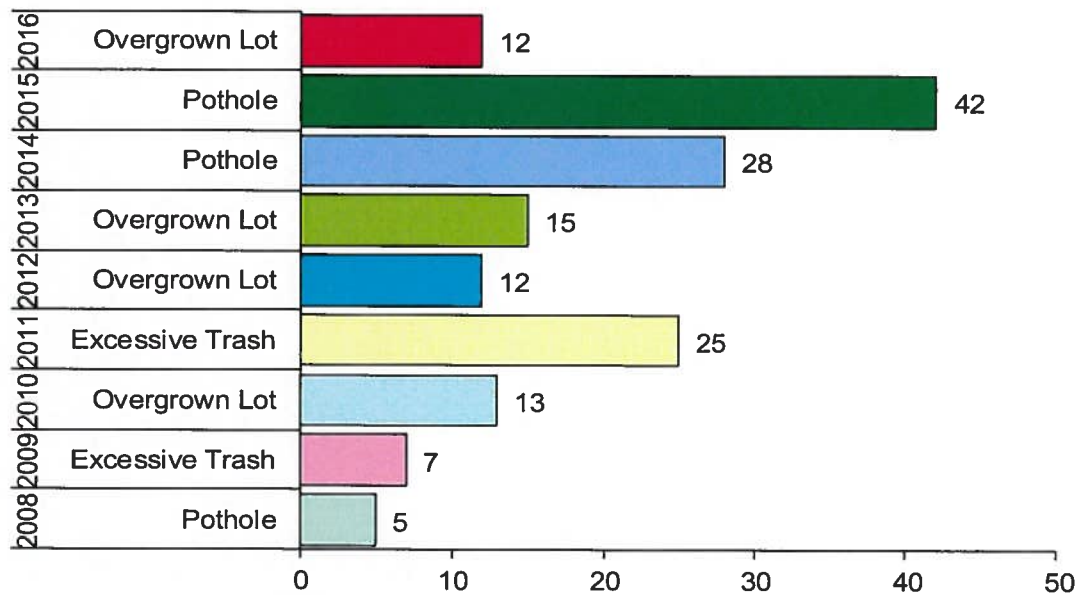

### 2008-2016 Service Request Summary

Citizens are able to input service requests that are forwarded directly to the appropriate department for action

Staff responds with the action to be taken and when the request is complete

There were a total of 864 service requests over the last 9 years

Community Development had the most requests with 27 total

The total time it took to complete a request in 2016 was the lowest it has ever been





# CITY OF KENT, OHIO

---

## DEPARTMENT OF COMMUNITY DEVELOPMENT Building Services Division

To: Dave Ruller  
City Manager

From: Bridget Susel  
Community Development Director *B.S.*

Date: January 9, 2017

RE: Monthly Permit and Zoning Complaint Report – December 2016

---

Attached are the monthly reports per council's request. If you have questions or require further information, please let us know.

# Permit Revenue Summary Report

Payment Date Range 11/28/16 - 12/31/16

Summary Listing

Fee Code	Fee Type	Billing Transactions	Adjustment Transactions	Amount Billed	Adjustments	Net Billed
<b>Permit Type ENGINEERING RES-ENGINEERING RESIDENTIAL</b>						
EXCAVATION - EXCAVATION		5	0	100.00	.00	100.00
SEWER RES - SEWER RESIDENTIAL		2	0	50.00	.00	50.00
WATER FEE - WATER FEE		2	0	50.00	.00	50.00
WATER MISC PARTS - WATER MISC PARTS		2	0	68.00	.00	68.00
Permit Type ENGINEERING RES-ENGINEERING RESIDENTIAL Totals		11	0	\$268.00	\$0.00	\$268.00
<b>Permit Type EXISTING COMM-EXISTING COMMERCIAL</b>						
3% BBS - 3% BBS		3	0	16.70	.00	16.70
COM-BUILD REPAIR - Commercial Building Repair/Remodel		3	0	556.40	.00	556.40
PLAN REVIEW <=3 - Plan Review for 3 or Less Reviews		7	0	1,612.50	.00	1,612.50
PLAN REVIEW 4+ - Plan Review for 4 or More Reviews		2	0	250.00	.00	250.00
Permit Type EXISTING COMM-EXISTING COMMERCIAL Totals		15	0	\$2,435.60	\$0.00	\$2,435.60
<b>Permit Type EXISTING RES-EXISTING RESIDENTIAL</b>						
1% BBS - 1% BBS		2	0	1.07	.00	1.07
RES-BUILD ADD 1 - Residential Building Addition- Single Family		1	0	57.00	.00	57.00
RES-BUILD REPAIR - Residential Building Remodel/Repair		1	0	50.00	.00	50.00
Permit Type EXISTING RES-EXISTING RESIDENTIAL Totals		4	0	\$108.07	\$0.00	\$108.07
<b>Permit Type FIRE ALARM-FIRE ALARM</b>						
3% BBS - 3% BBS		1	0	3.49	.00	3.49
COM-SUPR SYS RPR - Commercial Suppression Systems Repair/Remodel		1	0	116.42	.00	116.42
PLAN REVIEW <=3 - Plan Review for 3 or Less Reviews		2	0	75.00	.00	75.00
Permit Type FIRE ALARM-FIRE ALARM Totals		4	0	\$194.91	\$0.00	\$194.91
<b>Permit Type HVAC COMM-HVAC COMMERCIAL</b>						
3% BBS - 3% BBS		5	0	16.51	.00	16.51
COM-HVAC ADD - Commercial HVAC Addition		1	0	184.25	.00	184.25
COM-HVAC REPAIR - Commercial HVAC Repair/Remodel		2	0	265.90	.00	265.90
COM-HVAC REPLACE - Commercial HVAC Replacement		2	0	100.00	.00	100.00
Permit Type HVAC COMM-HVAC COMMERCIAL Totals		10	0	\$566.66	\$0.00	\$566.66
<b>Permit Type HVAC RES-HVAC RESIDENTIAL</b>						
1% BBS - 1% BBS		11	1	4.15	(.35)	3.80
RES-HVAC OWN RPL - Residential HVAC Owner Occupied Replacement		9	1	315.00	(35.00)	280.00
RES-HVAC REPAIR - Residential HVAC Repair/Remodel		2	0	100.00	.00	100.00
Permit Type HVAC RES-HVAC RESIDENTIAL Totals		22	2	\$419.15	(\$35.35)	\$383.80
<b>Permit Type PLUMB COMM-PLUMBING COMMERCIAL</b>						
3% BBS - 3% BBS		1	0	2.27	.00	2.27
COM-PLUMB REPAIR - Commercial Plumbing Repair/Remodel		1	0	75.60	.00	75.60
Permit Type PLUMB COMM-PLUMBING COMMERCIAL Totals		2	0	\$77.87	\$0.00	\$77.87
<b>Permit Type PLUMB RES-PLUMBING RESIDENTIAL</b>						
1% BBS - 1% BBS		10	0	5.10	.00	5.10

# Permit Revenue Summary Report

Payment Date Range 11/28/16 - 12/31/16

Summary Listing

Fee Code	Fee Type	Billing Transactions	Adjustment Transactions	Amount Billed	Adjustments	Net Billed
Permit Type ARB-ARCHITECTURAL REVIEW BOARD						
ARB SIGN REVIEW - SIGN REVIEW FOR ARCHITECTURAL REVIEW BOARD		1	0	50.00	.00	50.00
Permit Type ARB-ARCHITECTURAL REVIEW BOARD Totals						
		1	0	\$50.00	\$0.00	\$50.00
Permit Type DEMOLITION-DEMOLITION						
1% BBS - 1% BBS		2	0	.75	.00	.75
FEE IN LIEU SEWR - FEE IN LIEU FOR SEWER DISCONNECT		1	0	6,541.79	.00	6,541.79
FEE IN LIEU WATR - FEE IN LIEU FOR WATER DISCONNECT		1	0	4,545.99	.00	4,545.99
RES-DEMO ACCSRY - Residential Demolition/Moving Accessory Building		1	0	25.00	.00	25.00
RES-DEMO/MOVE - Residential Demolition/Moving		1	0	50.00	.00	50.00
Permit Type DEMOLITION-DEMOLITION Totals						
		6	0	\$11,163.53	\$0.00	\$11,163.53
Permit Type ELECTRICAL COMM-ELECTRICAL COMMERCIAL						
3% BBS - 3% BBS		4	0	13.72	.00	13.72
3% BBS OVERRIDE - 3% BBS OVERRIDE		1	0	1.50	.00	1.50
COM-ELEC ADD - Commercial Electric Addition		1	0	305.40	.00	305.40
COM-ELEC REPAIR - Commercial Electric Repair/Remodel		3	0	152.00	.00	152.00
CRES-ELECT SERVC - Commercial Residential Electrical Service		1	0	50.00	.00	50.00
Permit Type ELECTRICAL COMM-ELECTRICAL COMMERCIAL Totals						
		10	0	\$522.62	\$0.00	\$522.62
Permit Type ELECTRICAL RES-ELECTRICAL RESIDENTIAL						
1% BBS - 1% BBS		9	0	4.05	.00	4.05
RES-ELEC REPAIR - Residential Electric Repair/Repair		6	0	300.00	.00	300.00
RES-ELEC OWN SRV - Residential Electric Owner Occupied Service		3	0	105.00	.00	105.00
Permit Type ELECTRICAL RES-ELECTRICAL RESIDENTIAL Totals						
		18	0	\$409.05	\$0.00	\$409.05
Permit Type ENGINEERING COM-ENGINEERING COMMERCIAL						
BOND-CONST PERF - CONSTRUCTION GUARANTEE		1	0	1,011.00	.00	1,011.00
PERFORMANCE BOND						
EXCAVATION - EXCAVATION		5	0	100.00	.00	100.00
PLAN REV / INSP - ENGINEERING PLAN REVIEW / INSPECTION		1	0	202.20	.00	202.20
SEWER COMM - SEWER COMMERCIAL		1	0	75.00	.00	75.00
SEWER UTILIZE - SEWER UTILIZATION		1	0	1,310.00	.00	1,310.00
STORM COM PERMIT - STORM SEWER COMMERCIAL PERMIT		1	0	75.00	.00	75.00
W-METR 1" - WATER METER 1"		1	0	415.00	.00	415.00
W-METR 1.5" - WATER METER 1 1/2"		1	0	610.00	.00	610.00
W-TAP 1" +PRTS - WATER TAP 1" +MISC PARTS NO METER		1	0	440.00	.00	440.00
W-TAP 1.5" +PRTS - WATER TAP 1 1/2" +MISC PARTS NO METER		1	0	697.00	.00	697.00
WATER FEE - WATER FEE		2	0	50.00	.00	50.00
WATER UTILIZED - WATER UTILIZATION		1	0	550.00	.00	550.00
Permit Type ENGINEERING COM-ENGINEERING COMMERCIAL Totals						
		17	0	\$5,535.20	\$0.00	\$5,535.20

# Permit Revenue Summary Report

Payment Date Range 11/28/16 - 12/31/16

Summary Listing

Fee Code	Fee Type	Billing Transactions	Adjustment Transactions	Amount Billed	Adjustments	Net Billed
Permit Type <b>PLUMB RES-PLUMBING RESIDENTIAL</b>						
RES-PLUMB OWN RP - Residential Plumbing Owner Occupied Replacement		6	0	210.00	.00	210.00
RES-PLUMB REPAIR - Residential Plumbing Repair/Remodel		3	0	200.00	.00	200.00
RES-PLUMBING NEW - Residential Plumbing New		1	0	100.00	.00	100.00
	Permit Type <b>PLUMB RES-PLUMBING RESIDENTIAL</b> Totals	20	0	\$515.10	\$0.00	\$515.10
Permit Type <b>SUBDIVISION-SUBDIVISION</b>						
MIN SUB PLAT - MINOR SUBDIVISION PLAT		2	0	55.00	.00	55.00
	Permit Type <b>SUBDIVISION-SUBDIVISION</b> Totals	2	0	\$55.00	\$0.00	\$55.00
Permit Type <b>ZONING-ZONING</b>						
COM-ZONING PSIGN - Commercial Zoning Permanent Signs		1	0	50.00	.00	50.00
COM-ZONING TSIGN - Commercial Zoning Temporary Signs		1	0	25.00	.00	25.00
RES-ZONING ADD - Residential Zoning Addition		2	0	50.00	.00	50.00
	Permit Type <b>ZONING-ZONING</b> Totals	4	0	\$125.00	\$0.00	\$125.00
	Grand Totals	146	2	\$22,445.76	(\$35.35)	\$22,410.41

# Permit Revenue Summary Report

Payment Date Range 11/28/16 - 12/31/16

Detail Listing

Fee Code	Fee Type	Billing Transactions	Adjustment Transactions	Amount Billed	Adjustments	Net Billed
<b>Permit Type ARB-ARCHITECTURAL REVIEW BOARD</b>						
ARB SIGN REVIEW - SIGN REVIEW FOR ARCHITECTURAL REVIEW BOARD		1	0	50.00	.00	50.00
Date	Transaction Type	Permit Number	Issued To	Amount	Amount	
12/03/2016	Payment Monies Received	ARB16-018	GRAZERS	50.00	50.00	
					\$50.00	
<b>Permit Type ARB-ARCHITECTURAL REVIEW BOARD Totals</b>						
		1	0	\$50.00	\$0.00	\$50.00
<b>Permit Type DEMOLITION-DEMOLITION</b>						
1% BBS - 1% BBS		2	0	.75	.00	.75
Date	Transaction Type	Permit Number	Issued To	Amount	Amount	
11/29/2016	Payment Monies Received	2016-00000817	BUTCHER & SON, INC.	.50	.50	
11/29/2016	Payment Monies Received	2016-00000818	BISHOP BROTHERS	.25	.25	
					\$0.75	
<b>Permit Type ARB-ARCHITECTURAL REVIEW BOARD Totals</b>						
		1	0	6,541.79	.00	6,541.79
<b>Permit Type DEMOLITION-DEMOLITION</b>						
FEE IN LIEU SEWR - FEE IN LIEU FOR SEWER DISCONNECT		1	0	4,545.99	.00	4,545.99
Date	Transaction Type	Permit Number	Issued To	Amount	Amount	
12/03/2016	Payment Monies Received	2016-00000180	ANDY'S EMPIRE CONSTRUCTION & DEMOLITION	6,541.79	6,541.79	
					\$6,541.79	
<b>Permit Type DEMOLITION-DEMOLITION</b>						
FEE IN LIEU WATR - FEE IN LIEU FOR WATER DISCONNECT		1	0	25.00	.00	25.00
Date	Transaction Type	Permit Number	Issued To	Amount	Amount	
12/03/2016	Payment Monies Received	2016-00000180	ANDY'S EMPIRE CONSTRUCTION & DEMOLITION	4,545.99	4,545.99	
					\$4,545.99	
<b>Permit Type DEMOLITION-DEMOLITION</b>						
RES-DEMO ACCSRY - Residential Demolition/Moving Accessory		1	0	25.00	.00	25.00
Building	Transaction Type	Permit Number	Issued To	Amount	Amount	
11/29/2016	Payment Monies Received	2016-00000818	BISHOP BROTHERS	25.00	25.00	
					\$25.00	
<b>Permit Type DEMOLITION-DEMOLITION</b>						
RES-DEMO/MOVE - Residential Demolition/Moving		1	0	50.00	.00	50.00
Date	Transaction Type	Permit Number	Issued To	Amount	Amount	
11/29/2016	Payment Monies Received	2016-00000817	BUTCHER & SON, INC.	50.00	50.00	
					\$50.00	
<b>Permit Type DEMOLITION-DEMOLITION Totals</b>						
		6	0	\$11,163.53	\$0.00	\$11,163.53
<b>Permit Type ELECTRICAL COMM-ELECTRICAL COMMERCIAL</b>						
3% BBS - 3% BBS		4	0	13.72	.00	13.72
Date	Transaction Type	Permit Number	Issued To	Amount	Amount	
12/03/2016	Payment Monies Received	2016-00000828	DIES ELECTRIC LLC	1.50	1.50	
12/03/2016	Payment Monies Received	2016-00000831	THE PATTIE GROUP, INC	1.56	1.56	
12/03/2016	Payment Monies Received	2016-00000832	OTT ELECTRICAL SERVICES INC.	1.50	1.50	
12/20/2016	Payment Monies Received	2016-00000870	HORVATH ELECTRIC INC	9.16	9.16	



# Permit Revenue Summary Report

Payment Date Range 11/28/16 - 12/31/16

Detail Listing

Fee Code	Permit Type	Fee Type	Billing Transactions	Adjustment Transactions	Amount Billed	Adjustments	Net Billed
<b>ELECTRICAL COMM-ELECTRICAL COMMERCIAL</b>							
3% BBS OVERRIDE - 3% BBS OVERRIDE			1	0	1.50	.00	1.50
11/29/2016	Transaction Type	Permit Number	Issued To	Amount			
	Payment Monies Received	2016-00000821	SPEELMAN ELECTRIC INC.	1.50			
				\$13.72			
<b>COM-ELEC ADD - Commercial Electric Addition</b>							
12/20/2016	Transaction Type	Permit Number	Issued To	Amount			
	Payment Monies Received	2016-00000870	HORVATH ELECTRIC INC	305.40			305.40
				\$305.40			
<b>COM-ELEC REPAIR - Commercial Electric Repair/Remodel</b>							
12/03/2016	Transaction Type	Permit Number	Issued To	Amount			
12/03/2016	Payment Monies Received	2016-00000828	DIES ELECTRIC LLC	50.00			
12/03/2016	Payment Monies Received	2016-00000831	THE PATTIE GROUP, INC	52.00			
12/03/2016	Payment Monies Received	2016-00000832	OTT ELECTRICAL SERVICES INC.	50.00			
				\$152.00			152.00
<b>CRES-ELECT SERVC - Commercial Residential Electrical Service</b>							
11/29/2016	Transaction Type	Permit Number	Issued To	Amount			
	Payment Monies Received	2016-00000821	SPEELMAN ELECTRIC INC.	50.00			50.00
				\$50.00			
<b>Permit Type ELECTRICAL COMM-ELECTRICAL COMMERCIAL Totals</b>							
1% BBS - 1% BBS			10	0	\$522.62	\$0.00	\$522.62
11/29/2016	Transaction Type	Permit Number	Issued To	Amount			
11/29/2016	Payment Monies Received	2016-00000819	ANYTHING ELECTRIC LLC	.35			
11/29/2016	Payment Monies Received	2016-00000822	SIEFER ELECTRIC, INC	.50			
11/29/2016	Payment Monies Received	2016-00000824	THOMPSON ELECTRIC	.35			
12/13/2016	Payment Monies Received	2016-00000851	ECONO-ELECTRIC	.50			
12/20/2016	Payment Monies Received	2016-00000864	DAVID S RUSSELL	.50			
12/20/2016	Payment Monies Received	2016-00000865	DAVID S RUSSELL	.50			
12/20/2016	Payment Monies Received	2016-00000869	CAPRON ELECTRIC	.50			
12/20/2016	Payment Monies Received	2016-00000878	MARK A & AMY C KLINE	.50			
12/30/2016	Payment Monies Received	2016-00000880	THOMPSON ELECTRIC	.35			
				\$4.05			4.05
<b>Permit Type ELECTRICAL RES-ELECTRICAL RESIDENTIAL</b>							
RES-ELEC REPAIR - Residential Electric Remodel/Repair			6	0	300.00	.00	300.00
11/29/2016	Transaction Type	Permit Number	Issued To	Amount			
12/13/2016	Payment Monies Received	2016-00000822	SIEFER ELECTRIC, INC	50.00			
12/20/2016	Payment Monies Received	2016-00000851	ECONO-ELECTRIC	50.00			
12/20/2016	Payment Monies Received	2016-00000864	DAVID S RUSSELL	50.00			

# Permit Revenue Summary Report

Payment Date Range 11/28/16 - 12/31/16

Detail Listing

Fee Code	Fee Type	Billing Transactions	Adjustment Transactions	Amount Billed	Adjustments	Net Billed
<b>RES-ELEC OWN SRV - Residential Electric Owner Occupied</b>						
RES-ELEC REPAIR - Residential Electric Remodel/Repair		6	0	300.00	.00	300.00
	Transaction Type	Permit Number	Issued To	Amount		
	Payment Monies Received	2016-00000865	DAVID S RUSSELL	50.00		
	Payment Monies Received	2016-00000869	CAPRON ELECTRIC	50.00		
	Payment Monies Received	2016-00000878	MARK A & AMY C KLINE	50.00		
				<b>\$300.00</b>		
<b>RES-ELEC OWN SRV - Residential Electric Owner Occupied</b>						
		3	0	105.00	.00	105.00
	Transaction Type	Permit Number	Issued To	Amount		
	Payment Monies Received	2016-00000819	ANYTHING ELECTRIC LLC	35.00		
	Payment Monies Received	2016-00000824	THOMPSON ELECTRIC	35.00		
	Payment Monies Received	2016-00000880	THOMPSON ELECTRIC	35.00		
				<b>\$105.00</b>		
<b>Permit Type ELECTRICAL RES-ELECTRICAL RESIDENTIAL Totals</b>						
		18	0	\$409.05	\$0.00	\$409.05
<b>BOND-CONST PERF - CONSTRUCTION GUARANTEE</b>						
		1	0	1,011.00	.00	1,011.00
	Transaction Type	Permit Number	Issued To	Amount		
	Payment Monies Received	2016-00000114	MRF MACHINE & HYDRAULICS INC	1,011.00		
				<b>\$1,011.00</b>		
<b>EXCAVATION - EXCAVATION</b>						
		5	0	100.00	.00	100.00
	Transaction Type	Permit Number	Issued To	Amount		
	Payment Monies Received	2016-00000105	DOMINION EAST OHIO GAS	20.00		
	Payment Monies Received	2016-00000122	TAYLOR TELE-COMMUNICATIONS	20.00		
	Payment Monies Received	2016-00000124	KLINE & KAVALI	20.00		
	Payment Monies Received	2016-00000121	DIES ELECTRIC LLC	20.00		
	Payment Monies Received	2016-00000114	MRF MACHINE & HYDRAULICS INC	20.00		
				<b>\$100.00</b>		
<b>PLAN REV / INSP - ENGINEERING PLAN REVIEW / INSPECTION</b>						
		1	0	202.20	.00	202.20
	Transaction Type	Permit Number	Issued To	Amount		
	Payment Monies Received	2016-00000114	MRF MACHINE & HYDRAULICS INC	202.20		
				<b>\$202.20</b>		
<b>SEWER COMM - SEWER COMMERCIAL</b>						
		1	0	75.00	.00	75.00
	Transaction Type	Permit Number	Issued To	Amount		
	Payment Monies Received	2016-00000114	MRF MACHINE & HYDRAULICS INC	75.00		
				<b>\$75.00</b>		
<b>SEWER UTILIZE - SEWER UTILIZATION</b>						
		1	0	1,310.00	.00	1,310.00
	Transaction Type	Permit Number	Issued To	Amount		
	Payment Monies Received	2016-00000114	MRF MACHINE & HYDRAULICS INC	1,310.00		
				<b>\$1,310.00</b>		

# Permit Revenue Summary Report

Payment Date Range 11/28/16 - 12/31/16

Detail Listing

Fee Code	Fee Type	Billing Transactions	Adjustment Transactions	Amount Billed	Adjustments	Net Billed
Permit Type ENGINEERING COM-ENGINEERING COMMERCIAL						
STORM COM PERMIT - STORM SEWER COMMERCIAL PERMIT					\$1,310.00	
12/13/2016	Payment Monies Received	1 Permit Number 2016-00000114 Issued To MRF MACHINE & HYDRAULICS INC	0	75.00	.00	75.00
					Amount 75.00	
					\$75.00	
W-METR 1" - WATER METER 1"						415.00
12/13/2016	Payment Monies Received	1 Permit Number 2016-00000114 Issued To MRF MACHINE & HYDRAULICS INC	0	415.00	.00	415.00
					Amount 415.00	
					\$415.00	
W-METR 1.5" - WATER METER 1 1/2"						610.00
12/03/2016	Payment Monies Received	1 Permit Number 2016-00000124 Issued To KLINE & KAVALI	0	610.00	.00	610.00
					Amount 610.00	
					\$610.00	
W-TAP 1" +PRTS - WATER TAP 1" +MISC PARTS NO METER						440.00
12/13/2016	Payment Monies Received	1 Permit Number 2016-00000114 Issued To MRF MACHINE & HYDRAULICS INC	0	440.00	.00	440.00
					Amount 440.00	
					\$440.00	
W-TAP 1.5" +PRTS - WATER TAP 1 1/2" +MISC PARTS NO METER						697.00
12/03/2016	Payment Monies Received	1 Permit Number 2016-00000124 Issued To KLINE & KAVALI	0	697.00	.00	697.00
					Amount 697.00	
					\$697.00	
WATER FEE - WATER FEE						50.00
12/03/2016	Payment Monies Received	2 Permit Number 2016-00000124 Issued To KLINE & KAVALI	0	50.00	.00	50.00
					Amount 25.00	
					25.00	
					\$50.00	
WATER UTILIZED - WATER UTILIZATION						550.00
12/13/2016	Payment Monies Received	1 Permit Number 2016-00000114 Issued To MRF MACHINE & HYDRAULICS INC	0	550.00	.00	550.00
					Amount 550.00	
					\$550.00	
Permit Type ENGINEERING COM-ENGINEERING COMMERCIAL Totals						\$5,535.20
EXCAVATION - EXCAVATION						100.00
11/29/2016	Payment Monies Received	5 Permit Number 2016-00000120 Issued To BISHOP BROTHERS	0	100.00	.00	100.00
					Amount 20.00	
					20.00	
					20.00	
12/03/2016	Payment Monies Received	2016-00000123 KLINE & KAVALI				
12/09/2016	Payment Monies Received	2016-00000125 BISHOP BROTHERS				

# Permit Revenue Summary Report

Payment Date Range 11/28/16 - 12/31/16

Detail Listing

Fee Code	Permit Type	Fee Type	Billing Transactions	Adjustment Transactions	Amount Billed	Adjustments	Net Billed
	<b>ENGINEERING RES-ENGINEERING RESIDENTIAL</b>						
	<b>EXCAVATION - EXCAVATION</b>						
Date	Transaction Type	Permit Number	Issued To		Amount	Amount	
12/13/2016	Payment Monies Received	2016-00000130	DOMINION EAST OHIO GAS	5	100.00	20.00	100.00
12/20/2016	Payment Monies Received	2016-00000134	ROBERTS GENERAL EXCAVATION			20.00	
						\$100.00	
	<b>SEWER RES - SEWER RESIDENTIAL</b>						
Date	Transaction Type	Permit Number	Issued To		Amount	Amount	
11/29/2016	Payment Monies Received	2016-00000120	BISHOP BROTHERS	2	50.00	25.00	50.00
12/20/2016	Payment Monies Received	2016-00000134	ROBERTS GENERAL EXCAVATION			25.00	
						\$50.00	
	<b>WATER FEE - WATER FEE</b>						
Date	Transaction Type	Permit Number	Issued To		Amount	Amount	
12/03/2016	Payment Monies Received	2016-00000123	KLINE & KAVALI	2	50.00	25.00	50.00
12/09/2016	Payment Monies Received	2016-00000125	BISHOP BROTHERS			25.00	
						\$50.00	
	<b>WATER MISC PARTS - WATER MISC PARTS</b>						
Date	Transaction Type	Permit Number	Issued To		Amount	Amount	
12/03/2016	Payment Monies Received	2016-00000123	KLINE & KAVALI	2	68.00	34.00	68.00
12/09/2016	Payment Monies Received	2016-00000125	BISHOP BROTHERS			34.00	
						\$68.00	
	<b>ENGINEERING RES-ENGINEERING RESIDENTIAL</b>						
	<b>EXISTING COMM-EXISTING COMMERCIAL</b>						
Permit Type	Permit Type	Permit Type	Totals				
3% BBS - 3% BBS	3% BBS - 3% BBS	3% BBS - 3% BBS		11	\$268.00	\$0.00	\$268.00
Date	Transaction Type	Permit Number	Issued To		Amount	Amount	
11/29/2016	Payment Monies Received	2016-00000812	MARK R FABRY	3	16.70	3.04	16.70
11/29/2016	Payment Monies Received	2016-00000816	B. PERFECT CONSTRUCTION			7.55	
12/20/2016	Payment Monies Received	2016-00000860	KENT NATURAL FOODS COOP			6.11	
						\$16.70	
	<b>COM-BUILD REPAIR - Commercial Building Repair/Remodel</b>						
Date	Transaction Type	Permit Number	Issued To		Amount	Amount	
11/29/2016	Payment Monies Received	2016-00000812	MARK R FABRY	3	556.40	101.20	556.40
11/29/2016	Payment Monies Received	2016-00000816	B. PERFECT CONSTRUCTION			251.60	
12/20/2016	Payment Monies Received	2016-00000860	KENT NATURAL FOODS COOP			203.60	
						\$556.40	
	<b>PLAN REVIEW &lt;=3 - Plan Review for 3 or Less Reviews</b>						
Date	Transaction Type	Permit Number	Issued To		Amount	Amount	
11/29/2016	Payment Monies Received	2016-00000282	TROY CONSTRUCTION	7	1,612.50	75.00	1,612.50
11/29/2016	Payment Monies Received	2016-00000297	R2K CONTRACTING			75.00	

# Permit Revenue Summary Report

Payment Date Range 11/28/16 - 12/31/16

Detail Listing

Fee Code	Permit Type	Transaction Type	Permit Number	Billing Transactions	Adjustment Transactions	Amount Billed	Adjustments	Net Billed
<b>EXISTING COMM-EXISTING COMMERCIAL</b>								
PLAN REVIEW <=3 - Plan Review for 3 or Less Reviews				7	0	1,612.50	.00	1,612.50
		Transaction Type	Permit Number	Issued To			Amount	
11/29/2016		Payment Monies Received	2016-00000546	TROY CONSTRUCTION			75.00	
12/20/2016		Payment Monies Received	2016-00000860	KENT NATURAL FOODS COOP			75.00	
12/20/2016		Payment Monies Received	2016-00000860	KENT NATURAL FOODS COOP			337.50	
12/20/2016		Payment Monies Received	2016-00000860	KENT NATURAL FOODS COOP			337.50	
12/20/2016		Payment Monies Received	2016-00000860	KENT NATURAL FOODS COOP			637.50	
							<b>\$1,612.50</b>	
<b>PLAN REVIEW 4+ - Plan Review for 4 or More Reviews</b>								
		Transaction Type	Permit Number	Issued To			Amount	
11/29/2016		Payment Monies Received	2016-00000297	R2K CONTRACTING		250.00	125.00	250.00
12/20/2016		Payment Monies Received	2016-00000860	KENT NATURAL FOODS COOP			125.00	
							<b>\$250.00</b>	
						<b>\$2,435.60</b>	<b>\$0.00</b>	<b>\$2,435.60</b>
<b>EXISTING COMM-EXISTING COMMERCIAL Totals</b>								
Permit Type	EXISTING RES-EXISTING RESIDENTIAL			15	0	\$2,435.60	\$0.00	\$2,435.60
<b>1% BBS - 1% BBS</b>								
		Transaction Type	Permit Number	Issued To			Amount	
12/03/2016		Payment Monies Received	2016-00000826	KENNETH E MILLER		1.07	.57	1.07
12/13/2016		Payment Monies Received	2016-00000846	P & K CONTRACTING			.50	
							<b>\$1.07</b>	
<b>RES-BUILD ADD 1 - Residential Building Addition- Single Family</b>								
		Transaction Type	Permit Number	Issued To			Amount	
12/03/2016		Payment Monies Received	2016-00000826	KENNETH E MILLER		57.00	57.00	57.00
							<b>\$57.00</b>	
<b>RES-BUILD REPAIR - Residential Building Remodel/Repair</b>								
		Transaction Type	Permit Number	Issued To			Amount	
12/13/2016		Payment Monies Received	2016-00000846	P & K CONTRACTING		50.00	50.00	50.00
							<b>\$50.00</b>	
						<b>\$108.07</b>	<b>\$0.00</b>	<b>\$108.07</b>
<b>EXISTING RES-EXISTING RESIDENTIAL Totals</b>								
Permit Type	EXISTING RES-EXISTING RESIDENTIAL			4	0	\$108.07	\$0.00	\$108.07
<b>3% BBS - 3% BBS</b>								
		Transaction Type	Permit Number	Issued To			Amount	
11/29/2016		Payment Monies Received	2016-00000814	STRAYCO INC/DBA RADI-O-SOUND COMMUNICATION		3.49	3.49	3.49
							<b>\$3.49</b>	



# Permit Revenue Summary Report

Payment Date Range 11/28/16 - 12/31/16

Detail Listing

Fee Code	Permit Type	Transaction Type	Permit Number	Billing Transactions	Adjustment Transactions	Amount Billed	Adjustments	Net Billed
	COM-SUPR SYS RPR - Commercial Suppression Systems Repair/Remodel							
11/29/2016	Payment Monies Received	2016-00000814	1	0		116.42	.00	116.42
		Issued To					Amount	
		STRAYCO INC/DBA RADI-O-SOUND COMMUNICATION					116.42	
							\$116.42	
PLAN REVIEW <=3 - Plan Review for 3 or Less Reviews								
11/29/2016	Payment Monies Received	2016-00000814	2	0		75.00	.00	75.00
		Issued To					Amount	
		STRAYCO INC/DBA RADI-O-SOUND COMMUNICATION					37.50	
							37.50	
							\$75.00	
Permit Type FIRE ALARM-FIRE ALARM Totals								
			4	0		\$194.91	\$0.00	\$194.91
Permit Type HVAC COMM-HVAC COMMERCIAL								
11/29/2016	Payment Monies Received	2016-00000823	5	0		16.51	.00	16.51
		Issued To					Amount	
		AIRFLOW HEATING & AIR CONDITIONING					1.50	
		CLEVELAND AIR COMFORT CORPORATION					1.50	
		GREER HEATING & AIR CONDITIONING					2.67	
		WRIGHT HEATING & AIR CONDITIONING					5.53	
		SERVICE AIR, INC					5.31	
							\$16.51	
Permit Type FIRE ALARM-FIRE ALARM Totals								
			1	0		184.25	.00	184.25
COM-HVAC ADD - Commercial HVAC Addition								
12/20/2016	Payment Monies Received	2016-00000871	1	0		184.25	.00	184.25
		Issued To					Amount	
		WRIGHT HEATING & AIR CONDITIONING					184.25	
							\$184.25	
Permit Type HVAC COMM-HVAC COMMERCIAL Totals								
			2	0		265.90	.00	265.90
COM-HVAC REPAIR - Commercial HVAC Repair/Remodel								
12/20/2016	Payment Monies Received	2016-00000862	2	0		265.90	.00	265.90
		Issued To					Amount	
		GREER HEATING & AIR CONDITIONING					89.00	
		SERVICE AIR, INC					176.90	
							\$265.90	
Permit Type HVAC COMM-HVAC COMMERCIAL Totals								
			2	0		100.00	.00	100.00
COM-HVAC REPLACE - Commercial HVAC Replacement								
11/29/2016	Payment Monies Received	2016-00000823	2	0		100.00	.00	100.00
		Issued To					Amount	
		AIRFLOW HEATING & AIR CONDITIONING					50.00	
		CLEVELAND AIR COMFORT CORPORATION					50.00	
							\$100.00	
Permit Type HVAC COMM-HVAC COMMERCIAL Totals								
			10	0		\$566.66	\$0.00	\$566.66

# Permit Revenue Summary Report

Payment Date Range 11/28/16 - 12/31/16  
Detail Listing

Fee Code	Permit Type	Transaction Type	Permit Number	Billing Transactions	Adjustment Transactions	Amount Billed	Adjustments	Net Billed
1% BBS - 1% BBS	HVAC RES-HVAC RESIDENTIAL							
		Transaction Type	Permit Number	11	1	4.15	(.35)	3.80
		Payment Monies Received	2016-00000820	Issued To			Amount	
		Payment Monies Received	2016-00000842	GREER HEATING & AIR CONDITIONING			.50	
		Payment Monies Received	2016-00000843	CROWN HEATING & COOLING INC			.35	
		Payment Monies Received	2016-00000844	CROWN HEATING & COOLING INC			.35	
		Payment Monies Received	2016-00000849	BLIND & SONS			.35	
		Payment Monies Received	2016-00000850	BLIND & SONS			.35	
		Payment Monies Received	2016-00000853	D C HEATING & COOLING INC.			.50	
		Payment Monies Received	2016-00000863	GREER HEATING & AIR CONDITIONING			.35	
		Payment Monies Received	2016-00000868	GREER HEATING & AIR CONDITIONING			.35	
		Payment Monies Received	2016-00000874	WRIGHT HEATING & AIR CONDITIONING			.35	
		Payment Monies Received	2016-00000877	HAGAN HEATING & PLUMBING			.35	
		Adjustment	2016-00000877	HAGAN HEATING & PLUMBING			(.35)	
							\$3.80	
				9	1	315.00	(35.00)	280.00
	RES-HVAC OWN RPL - Residential HVAC Owner Occupied Replacement	Transaction Type	Permit Number	Issued To			Amount	
		Payment Monies Received	2016-00000842	CROWN HEATING & COOLING INC			35.00	
		Payment Monies Received	2016-00000843	CROWN HEATING & COOLING INC			35.00	
		Payment Monies Received	2016-00000844	BLIND & SONS			35.00	
		Payment Monies Received	2016-00000849	BLIND & SONS			35.00	
		Payment Monies Received	2016-00000853	GREER HEATING & AIR CONDITIONING			35.00	
		Payment Monies Received	2016-00000863	GREER HEATING & AIR CONDITIONING			35.00	
		Payment Monies Received	2016-00000868	WRIGHT HEATING & AIR CONDITIONING			35.00	
		Payment Monies Received	2016-00000874	HAGAN HEATING & PLUMBING			35.00	
		Payment Monies Received	2016-00000877	HAGAN HEATING & PLUMBING			35.00	
		Adjustment	2016-00000877	HAGAN HEATING & PLUMBING			(35.00)	
							\$280.00	
				2	0	100.00	.00	100.00
	RES-HVAC REPAIR - Residential HVAC Repair/Remodel	Transaction Type	Permit Number	Issued To			Amount	
		Payment Monies Received	2016-00000820	GREER HEATING & AIR CONDITIONING			50.00	
		Payment Monies Received	2016-00000850	D C HEATING & COOLING INC.			50.00	
							\$100.00	
				22	2	\$419.15	(\$35.35)	\$383.80
	3% BBS - 3% BBS	Permit Type	HVAC RES-HVAC RESIDENTIAL		Totals			
		Transaction Type	Permit Number	Issued To			Amount	
		Payment Monies Received	2016-00000854	FREEDOM PLUMBING CORP			2.27	
							2.27	
				1	0	2.27	.00	2.27
							Amount	
							2.27	

# Permit Revenue Summary Report

Payment Date Range 11/28/16 - 12/31/16

Detail Listing

Fee Code	Permit Type	PLUMB COMM-PLUMBING COMMERCIAL	Fee Type	Billing Transactions	Adjustment Transactions	Amount Billed	Adjustments	Net Billed
							\$2.27	
COM-PLUMB REPAIR - Commercial Plumbing Repair/Remodel				1	0	75.60	.00	75.60
12/13/2016	Transaction Type			Issued To			Amount	
	Payment Monies Received			FREEDOM PLUMBING CORP			75.60	
				Permit Number			\$75.60	
				2016-00000854				
				2	0	\$77.87	\$0.00	\$77.87
	Permit Type	PLUMB COMM-PLUMBING COMMERCIAL Totals						
1% BBS - 1% BBS				10	0	5.10	.00	5.10
12/03/2016	Transaction Type			Issued To			Amount	
12/03/2016	Payment Monies Received			STARS AND STRIPES PLUMBING			.50	
12/03/2016	Payment Monies Received			STARS AND STRIPES PLUMBING			1.00	
12/03/2016	Payment Monies Received			WIESE PLUMBING & HEATING			.35	
12/03/2016	Payment Monies Received			WIESE PLUMBING & HEATING			.35	
12/13/2016	Payment Monies Received			BATH FITTER			.50	
12/13/2016	Payment Monies Received			SAL'S HEATING & COOLING			.35	
12/20/2016	Payment Monies Received			BLIND & SONS			.35	
12/20/2016	Payment Monies Received			ACE BROTHERS PLUMBING			1.00	
12/20/2016	Payment Monies Received			HAGAN HEATING & PLUMBING			.35	
12/20/2016	Payment Monies Received			HAGAN HEATING & PLUMBING			.35	
							\$5.10	
RES-PLUMB OWN RP - Residential Plumbing Owner Occupied Replacement				6	0	210.00	.00	210.00
12/03/2016	Transaction Type			Issued To			Amount	
12/03/2016	Payment Monies Received			WIESE PLUMBING & HEATING			35.00	
12/13/2016	Payment Monies Received			WIESE PLUMBING & HEATING			35.00	
12/20/2016	Payment Monies Received			SAL'S HEATING & COOLING			35.00	
12/20/2016	Payment Monies Received			BLIND & SONS			35.00	
12/20/2016	Payment Monies Received			HAGAN HEATING & PLUMBING			35.00	
12/20/2016	Payment Monies Received			HAGAN HEATING & PLUMBING			35.00	
							\$210.00	
RES-PLUMB REPAIR - Residential Plumbing Repair/Remodel				3	0	200.00	.00	200.00
12/03/2016	Transaction Type			Issued To			Amount	
12/13/2016	Payment Monies Received			STARS AND STRIPES PLUMBING			50.00	
12/20/2016	Payment Monies Received			BATH FITTER			50.00	
12/20/2016	Payment Monies Received			ACE BROTHERS PLUMBING			100.00	
							\$200.00	
RES-PLUMBING NEW - Residential Plumbing New				1	0	100.00	.00	100.00
12/03/2016	Transaction Type			Issued To			Amount	
	Payment Monies Received			STARS AND STRIPES PLUMBING			100.00	

# Permit Revenue Summary Report

Payment Date Range 11/28/16 - 12/31/16

Detail Listing

Fee Code	Fee Type	Billing Transactions	Adjustment Transactions	Amount Billed	Adjustments	Net Billed
Permit Type <b>PLUMB RES-PLUMBING RESIDENTIAL</b>						
Permit Type <b>PLUMB RES-PLUMBING RESIDENTIAL</b> Totals						
		20	0	\$515.10	\$0.00	\$515.10
Permit Type <b>SUBDIVISION-SUBDIVISION</b>						
MIN SUB PLAT - MINOR SUBDIVISION PLAT						
Date	Transaction Type	Permit Number	Issued To	Amount		
11/29/2016	Payment Monies Received	2016-00000118	NANCY L DEISCHL	30.00		55.00
12/13/2016	Payment Monies Received	2016-00000126	COLEMAN PROFESSIONAL SERVICES INC	25.00		
				\$55.00		
Permit Type <b>SUBDIVISION-SUBDIVISION</b> Totals						
		2	0	\$55.00	\$0.00	\$55.00
Permit Type <b>ZONING-ZONING</b>						
COM-ZONING PSIGN - Commercial Zoning Permanent Signs						
Date	Transaction Type	Permit Number	Issued To	Amount		
12/12/2016	Payment Monies Received	2016-00000835	ADVANCED DISPLAY SYSTEMS LTD	50.00		50.00
				\$50.00		
Permit Type <b>ZONING-ZONING</b> Totals						
		1	0	25.00	.00	25.00
Permit Type <b>ZONING-ZONING</b>						
COM-ZONING TSIGN - Commercial Zoning Temporary Signs						
Date	Transaction Type	Permit Number	Issued To	Amount		
12/13/2016	Payment Monies Received	2016-00000839	GOOSE 2.5 LP	25.00		
				\$25.00		
Permit Type <b>ZONING-ZONING</b> Totals						
		2	0	50.00	.00	50.00
Permit Type <b>ZONING-ZONING</b>						
RES-ZONING ADD - Residential Zoning Addition						
Date	Transaction Type	Permit Number	Issued To	Amount		
12/03/2016	Payment Monies Received	2016-00000825	JOEL BROSIUS	25.00		
12/03/2016	Payment Monies Received	2016-00000827	KENNETH E MILLER	25.00		
				\$50.00		
Permit Type <b>ZONING-ZONING</b> Totals						
		4	0	\$125.00	\$0.00	\$125.00
Grand Totals						
		146	2	\$22,445.76	(\$35.35)	\$22,410.41

# Case by Inspector Report

Date Type: Open Date

From Date: 12/01/2016 - To Date: 12/31/2016

Case Type	Case Number	Status/Priority	Description	Case Date	Resolution Date	Open Period In Days	Reported By	Location
Inspector: ZONING-ROOMING HOUSE	Paul Bauer 2016-00001174	Active	rooming house	12/01/2016		39	Paul J. Bauer	210 S MANTUA ST KENT, OH 44240
PROPERTY MAINTENANCE	2016-00001185	Active	gaps in foundation	12/05/2016		35	Paul J. Bauer	335 N WATER ST KENT, OH 44240
PROPERTY MAINTENANCE	2016-00001186	Active	garage leaning w/ roof damage	12/05/2016		35	Paul J. Bauer	341 N WATER ST KENT, OH 44240
PROPERTY MAINTENANCE	2016-00001187	Active	paint	12/05/2016		35	Paul J. Bauer	620 WOODSIDE DR KENT, OH 44240
UNSHELTERED STORAGE-DEBRIS	2016-00001201	Active	collapsed tent in front yard	12/13/2016		27	Paul J. Bauer	302 UNIVERSITY AVE KENT, OH 44240
ZONING-ROOMING HOUSE	2016-00001207	Active	unlicensed rooming house	12/16/2016		24	Marla A. Dunn	800 FRANKLIN AVE KENT, OH 44240
ZONING-ROOMING HOUSE	2016-00001208	Active	unlicensed rooming house	12/16/2016		24	Paul J. Bauer	233 HIGHLAND AVE KENT, OH 44240
UNSHELTERED STORAGE-DEBRIS	2016-00001211	Active	bags of trash, many old tires	12/16/2016		24	Paul J. Bauer	1169 W MAIN ST KENT, OH 44240
UNSHELTERED STORAGE-VEHICLE	2016-00001214	Active	exp temp tags	12/20/2016		20	RoseMary Kline-Shardy	692 SILVER MEADOWS BLVD KENT, OH 44240
PROPERTY MAINTENANCE	2016-00001217	Active	broken door, smoke detectors, holes in wall, exposed wiring	12/20/2016		20	Abigail Lavelly	1641 OLYMPUS DR KENT, OH 44240
ZONING-ROOMING HOUSE	2016-00001218	Active	unlicensed rooming house	12/21/2016		19	Paul J. Bauer	1641 OLYMPUS DR KENT, OH 44240
ZONING-ROOMING HOUSE	2016-00001221	Active	unlicensed rooming house	12/21/2016		19	Paul J. Bauer	1639 OLYMPUS DR KENT, OH 44240
ZONING-ROOMING HOUSE	2016-00001224	Active	unlicensed rooming houses	12/21/2016		19	Paul J. Bauer	1635 OLYMPUS DR KENT, OH 44240
PROPERTY MAINTENANCE	2016-00001226	Active	frozen/burst pipes and clogged sanitary	12/22/2016		18	caller to PD	427 ROCKWELL ST KENT, OH 44240
UNSHELTERED STORAGE-DEBRIS	2016-00001227	Active	bags trash on tree lawn	12/22/2016		18	Paul J. Bauer	534 VINE ST KENT, OH 44240
PROPERTY MAINTENANCE	2016-00001230	Active	footers/foundation broken	12/23/2016		17	Paul J. Bauer	500 S DEPEYSTER ST KENT, OH 44240
ZONING	2016-00001233	Active	temporary sign	12/23/2016		17	Paul J. Bauer	216 UNIVERSITY DR KENT, OH 44240
PROPERTY MAINTENANCE	2016-00001236	Active	Cats, cats, cats. Also, junk car, mattresses, broken windows	12/29/2016		11	George J. Darlas	464 FRANCIS ST KENT, OH 44240



# Case by Inspector Report

Date Type: Open Date

From Date: 12/01/2016 - To Date: 12/31/2016

Case Type	Case Number	Status/Priority	Description	Case Date	Resolution Date	Open Period in Days	Reported By	Location
ZONING--ROOMING HOUSE	2016-00001238	Active	2 tenants plus Airbnb on third floor	12/29/2016		11	Paul J. Bauer	170 N PROSPECT AVE KENT, OH 44240
UNSHeltered STORAGE-DEBRIS	2016-00001241	Active	trash/filter in parking lot and adjacent property	12/29/2016		11	John M. Kuhar	1800 RHODES RD KENT, OH 44240
<b>Paul Bauer Totals:</b>								
Grand Totals :								
20 Case(s)								
20 Case(s)								

## Case by Inspector Report

Date Type: Open Date

From Date: 12/01/2016 - To Date: 12/31/2016

Case Type	Case Number	Status/Priority	Description	Case Date	Resolution Date	Open Period in Days	Reported By	Location
Inspector: ZONING-ROOMING HOUSE	Paul Bauer 2016-00001174	Active	rooming house	12/01/2016		39	Paul J. Bauer	210 S MANTUA ST KENT, OH 44240
PROPERTY MAINTENANCE	2016-00001185	Active	gaps in foundation	12/05/2016		35	Paul J. Bauer	335 N WATER ST KENT, OH 44240
PROPERTY MAINTENANCE	2016-00001186	Active	garage leaning w/ roof damage	12/05/2016		35	Paul J. Bauer	341 N WATER ST KENT, OH 44240
PROPERTY MAINTENANCE	2016-00001187	Active	paint	12/05/2016		35	Paul J. Bauer	620 WOODSIDE DR KENT, OH 44240
UNSHELTERED STORAGE-DEBRIS	2016-00001201	Active	collapsed tent in front yard	12/13/2016		27	Paul J. Bauer	302 UNIVERSITY AVE KENT, OH 44240
ZONING-ROOMING HOUSE	2016-00001207	Active	unlicensed rooming house	12/16/2016		24	Maria A. Dunn	800 FRANKLIN AVE KENT, OH 44240
ZONING-ROOMING HOUSE	2016-00001208	Active	unlicensed rooming house	12/16/2016		24	Paul J. Bauer	233 HIGHLAND AVE KENT, OH 44240
UNSHELTERED STORAGE-DEBRIS	2016-00001211	Active	bags of trash, many old tires	12/16/2016		24	Paul J. Bauer	1169 W MAIN ST KENT, OH 44240
UNSHELTERED STORAGE-VEHICLE	2016-00001214	Active	exp temp tags	12/20/2016		20	RoseMary Kline-Shardy	692 SILVER MEADOWS BLVD KENT, OH 44240
PROPERTY MAINTENANCE	2016-00001217	Active	broken door, smoke detectors, holes in wall, exposed wiring	12/20/2016		20	Abigail Lavelly	1641 OLYMPUS DR KENT, OH 44240
ZONING-ROOMING HOUSE	2016-00001218	Active	unlicensed rooming house	12/21/2016		19	Paul J. Bauer	1641 OLYMPUS DR KENT, OH 44240
ZONING-ROOMING HOUSE	2016-00001221	Active	unlicensed rooming house	12/21/2016		19	Paul J. Bauer	1639 OLYMPUS DR KENT, OH 44240
ZONING-ROOMING HOUSE	2016-00001224	Active	unlicensed rooming houses	12/21/2016		19	Paul J. Bauer	1635 OLYMPUS DR KENT, OH 44240
PROPERTY MAINTENANCE	2016-00001226	Active	frozen/burst pipes and clogged sanitary	12/22/2016		18	caller to PD	427 ROCKWELL ST KENT, OH 44240
UNSHELTERED STORAGE-DEBRIS	2016-00001227	Active	bags trash on tree lawn	12/22/2016		18	Paul J. Bauer	534 VINE ST KENT, OH 44240
PROPERTY MAINTENANCE	2016-00001230	Active	footers/foundation broken	12/23/2016		17	Paul J. Bauer	500 S DEPEYSTER ST KENT, OH 44240
ZONING	2016-00001233	Active	temporary sign	12/23/2016		17	Paul J. Bauer	216 UNIVERSITY DR KENT, OH 44240
PROPERTY MAINTENANCE	2016-00001236	Active	Cats, cats, cats. Also, junk car, mattresses, broken windows	12/29/2016		11	George J. Darlas	464 FRANCIS ST KENT, OH 44240

# Case by Inspector Report

Date Type: Open Date

From Date: 12/01/2016 - To Date: 12/31/2016

Case Type	Case Number	Status/Priority	Description	Case Date	Resolution Date	Open Period In Days	Reported By	Location
ZONING-ROOMING HOUSE	2016-00001238	Active	2 tenants plus Airbnb on third floor	12/29/2016		11	Paul J. Bauer	170 N PROSPECT AVE KENT, OH 44240
UNSHELTERED STORAGE-DEBRIS	2016-00001241	Active	trash/litter in parking lot and adjacent property	12/29/2016		11	John M. Kuhar	1800 RHODES RD KENT, OH 44240
<b>Paul Bauer Totals:</b>		20 Case(s)						
<b>Grand Totals :</b>		20 Case(s)						