

TRAFFIC CRASH REPORT

*DENOTES MANDATORY FIELD FOR SUPPLEMENT REPORT

LOCAL REPORT NUMBER*

<input type="checkbox"/> PHOTOS TAKEN <input type="checkbox"/> SECONDARY CRASH <input type="checkbox"/> PRIVATE PROPERTY	<input type="checkbox"/> OH-2 <input type="checkbox"/> OH-1P <input type="checkbox"/> OTHER	<input type="checkbox"/> OH-3 <input type="checkbox"/> OTHER	LOCAL INFORMATION REPORTING AGENCY NAME* City of Kent Police	NCIC* 0,6,7,0,3	LOCAL REPORT NUMBER* 2,0,2,0 - 0,0,0,2,0,9,4,2
--	---	---	---	---------------------------	--

COUNTY* 6,7	LOCALITY* 1-CITY 1	LOCATION: CITY, VILLAGE, TOWNSHIP* Kent	CRASH DATE / TIME* 12282020/1531	CRASH SEVERITY 1 - FATAL 2 - SERIOUS INJURY SUSPECTED 3 - MINOR INJURY SUSPECTED 4 - INJURY POSSIBLE 5 - PROPERTY DAMAGE ONLY 5
-----------------------	---------------------------------	---	--	--

ROUTE TYPE S T	ROUTE NUMBER 41,1,6,3,4,0,2	PREFIX LAKE	LOCATION ROAD NAME LAKE	ROAD TYPE S T	LATITUDE DECIMAL DEGREES 41,1,6,3,4,0,2
ROUTE TYPE A V	ROUTE NUMBER 81,3,3,9,5,8,0	PREFIX VIRGINIA	REFERENCE ROAD NAME (ROAD, MILEPOST, HOUSE #) VIRGINIA	ROAD TYPE A V	LONGITUDE DECIMAL DEGREES 81,3,3,9,5,8,0

REFERENCE POINT 1 - INTERSECTION 1 2 - MILE POST 3 - HOUSE #	DIRECTION FROM REFERENCE 1 - NORTH 3 2 - SOUTH 3 - EAST 4 - WEST	ROUTE TYPE IR - INTERSTATE ROUTE(TP) US - FEDERAL US ROUTE SR - STATE ROUTE CR - NUMBERED COUNTY ROUTE TR - NUMBERED TOWNSHIP ROUTE	ROAD TYPE AL - ALLEY AV - AVENUE BL - BOULEVARD CR - CIRCLE CT - COURT DR - DRIVE HE - HEIGHTS HW - HIGHWAY LA - LANE MP - MILEPOST OV - OVAL PK - PARKWAY PI - PIKE PL - PLACE RD - ROAD SQ - SQUARE ST - STREET TE - TERRACE TL - TRAIL WA - WAY	INTERSECTION RELATED <input type="checkbox"/> WITHIN INTERSECTION OR ON APPROACH <input type="checkbox"/> WITHIN INTERCHANGE AREA NUMBER OF APPROACHES ROADWAY <input type="checkbox"/> ROADWAY DIVIDED
---	--	--	--	--

LOCATION OF FIRST HARMFUL EVENT 1 - ON ROADWAY 0,1 2 - ON SHOULDER 3 - IN MEDIAN 4 - ON ROADSIDE 5 - ON GORE 6 - OUTSIDE TRAFFIC WAY 7 - ON RAMP 8 - OFF RAMP	MANNER OF CRASH COLLISION/IMPACT 1 - NOT COLLISION BETWEEN TWO MOTOR VEHICLES IN TRANSPORT 1 2 - REAR-END 3 - HEAD-ON 4 - REAR-TO-REAR 5 - BACKING 6 - ANGLE 7 - SIDESWIPE, SAME DIRECTION 8 - SIDESWIPE, OPPOSITE DIRECTION 9 - OTHER / UNKNOWN	DIRECTION OF TRAVEL 1 - NORTH 2 - SOUTH 3 - EAST 4 - WEST	MEDIAN TYPE 1 - DIVIDED FLUSH MEDIAN (<4 FEET) 2 - DIVIDED FLUSH MEDIAN (≥4 FEET) 3 - DIVIDED, DEPRESSED MEDIAN 4 - DIVIDED, RAISED MEDIAN (ANY TYPE) 9 - OTHER/UNKNOWN
---	---	---	--

<input type="checkbox"/> WORK ZONE RELATED <input type="checkbox"/> WORKERS PRESENT <input type="checkbox"/> LAW ENFORCEMENT PRESENT <input type="checkbox"/> ACTIVE SCHOOL ZONE	WORK ZONE TYPE 1 - LANE CLOSURE 2 - LANE SHIFT/CROSSOVER 3 - WORK ON SHOULDER OR MEDIAN 4 - INTERMITTENT OR MOVING WORK 5 - OTHER	LOCATION OF CRASH IN WORK ZONE 1 - BEFORE THE 1ST WORK ZONE WARNING SIGN 2 - ADVANCE WARNING AREA 3 - TRANSITION AREA 4 - ACTIVITY AREA 5 - TERMINATION AREA	CONTOUR 1 1 - STRAIGHT LEVEL 2 - STRAIGHT GRADE 3 - CURVE LEVEL 4 - CURVE GRADE 9 - OTHER/UNKNOWN	CONDITIONS 1 1 - DRY 2 - WET 3 - SNOW 4 - ICE 5 - SAND, MUD, DIRT, OIL, GRAVEL 6 - WATER (STANDING, MOVING) 7 - SLUSH 9 - OTHER/UNKNOWN	SURFACE 2 1 - CONCRETE 2 - BLACKTOP, BITUMINOUS, ASPHALT 3 - BRICK/BLOCK 4 - SLAG, GRAVEL, STONE 5 - DIRT 9 - OTHER/UNKNOWN
---	--	---	--	---	---

LIGHT CONDITION 2 1 - DAYLIGHT 2 - DAWN/DUSK 3 - DARK - LIGHTED ROADWAY 4 - DARK - ROADWAY NOT LIGHTED 5 - DARK - UNKNOWN ROADWAY LIGHTING 9 - OTHER / UNKNOWN	WEATHER 0,2 1 - CLEAR 2 - CLOUDY 3 - FOG, SMOG, SMOKE 4 - RAIN 5 - SLEET, HAIL 6 - SNOW 7 - SEVERE CROSSWINDS 8 - BLOWING SAND, SOIL, DIRT, SNOW 9 - FREEZING RAIN OR FREEZING DRIZZLE 99 - OTHER / UNKNOWN
--	---

NARRATIVE

UNIT 1 WAS TRAVELING WB ON LAKE ST.

UNIT 1 WAS THEN STRUCK BY A DOG RUNNING FROM THE SOUTH SIDE OF LAKE ST STRIKING THE RIGHT SIDE OF THE VEHICLE.

DL RV774666, OWNER OF DOG, WAS CITED FOR DOG AT LARGE. DL RESIDES AT 1419 GRAHAM AVE. HER DOG RAN OUT OF FRONT DOOR, ACROSS LAKE ST., AND THEN BACK ACROSS LAKE ST. STRIKING UNIT 1.

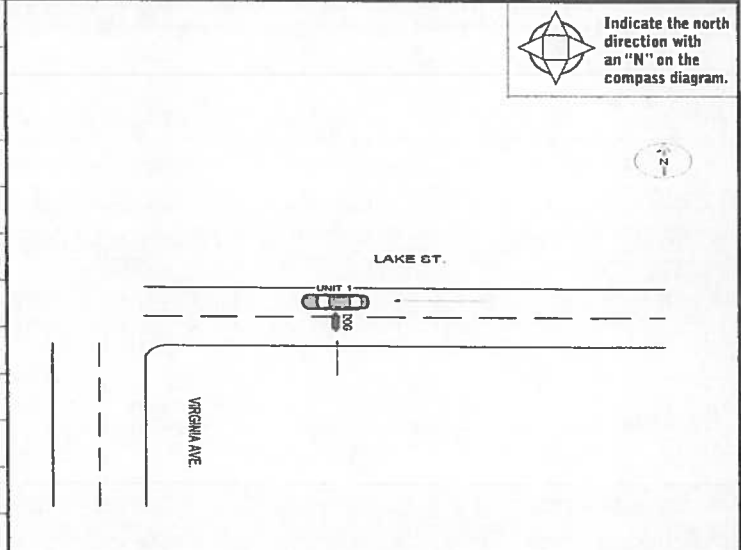

CRASH REPORTED DATE / TIME 1,2,2,8,2,0,2,0 / 1,5,3,1	DISPATCH DATE / TIME 1,2,2,8,2,0,2,0 / 1,5,3,1	ARRIVAL DATE / TIME 1,2,2,8,2,0,2,0 / 1,5,4,1	SCENE CLEARED DATE / TIME 1,2,2,8,2,0,2,0 / 1,6,0,9	REPORT TAKEN BY <input checked="" type="checkbox"/> POLICE AGENCY <input type="checkbox"/> MOTORIST <input type="checkbox"/> SUPPLEMENT (CORRECTION OR ADDITION TO AN EXISTING REPORT SEAT TO 2099)
TOTAL TIME ROADWAY CLOSED 0,3,8	OTHER INVESTIGATION TIME 0,2,0	TOTAL MINUTES 0,5,8	OFFICER'S NAME* Moore, Matthew J	CHECKED BY OFFICER'S NAME* Wheeler, George
			OFFICER'S BADGE NUMBER* 2,5,2	CHECKED BY OFFICER'S BADGE NUMBER* 2,4,3

OWNER

UNIT # 0, 1 OWNER NAME: LAST, FIRST, MIDDLE (☒ SAME AS DRIVER) **NICHOLLS, KATHRYN, MARIE**

OWNER ADDRESS: STREET, CITY, STATE, ZIP (☒ SAME AS DRIVER) **4011 DAWLEY RD, Ravenna Twp, OH 44266**

COMMERCIAL CARRIER: NAME, ADDRESS, CITY, STATE, ZIP _____ COMMERCIAL CARRIER PHONE: INCLUDE AREA CODE _____

VEHICLE

LP STATE O, H LICENSE PLATE # GPH7831 VEHICLE IDENTIFICATION # 2G11Z5SL7F9248218 VEHICLE YEAR 2015 VEHICLE MAKE Chevrolet

INSURANCE VERIFIED INSURANCE COMPANY ERIE INSURANCE INSURANCE POLICY # Q117002959 COLOR BLU VEHICLE MODEL MALIBU

COMMERCIAL GOVERNMENT IN EMERGENCY RESPONSE US DOT # _____ TOWED BY: COMPANY NAME _____

INTERLOCK DEVICE EQUIPPED HIT/SKIP UNIT #OCCUPANTS 0, 2 VEHICLE WEIGHT GVWR/GCWR 1 - <10K LBS. 2 - 10,001 - 26K LBS. 3 - >26K LBS. HAZARDOUS MATERIAL MATERIAL RELEASED CLASS # PLACARD ID # PLACARD _____

UNIT TYPE

0, 1 1 - PASSENGER CAR 7 - MOTORCYCLE 2-WHEELED 12 - GOLF CART 18 - LIMO (LIVERY VEHICLE) 23 - PEDESTRIAN / SKATER

00 # of TRAILING UNITS _____ 2 - PASSENGER VAN (MINIVAN) 8 - MOTORCYCLE 3-WHEELED 13 - SNOWMOBILE 19 - BUS (6+ PASSENGERS) 24 - WHEELCHAIR (ANY TYPE)

3 - SPORT UTILITY VEHICLE 9 - AUTOCYCLE 14 - SINGLE UNIT TRUCK 20 - OTHER VEHICLE 25 - OTHER NON-MOTORIST

4 - PICK UP 10 - MOPED OR MOTORIZED BICYCLE 15 - SEMI-TRACTOR 21 - HEAVY EQUIPMENT 26 - BICYCLE

5 - CARGO VAN 11 - ALL TERRAIN VEHICLE (ATV / UTV) 16 - FARM EQUIPMENT 22 - ANIMAL WITH RIDER OR ANIMAL-DRAWN VEHICLE 99 - UNKNOWN OR HITSKIP

6 - VAN (9-15 SEATS) 17 - MOTORHOME

WAS VEHICLE OPERATING IN AUTONOMOUS MODE WHEN CRASH OCCURRED? 2 1 - YES 2 - NO 9 - OTHER / UNKNOWN AUTONOMOUS MODE LEVEL 0 0 - NO AUTOMATION 1 - DRIVER ASSISTANCE 2 - PARTIAL AUTOMATION 3 - CONDITIONAL AUTOMATION 4 - HIGH AUTOMATION 5 - FULL AUTOMATION 9 - UNKNOWN

SPECIAL FUNCTION

0, 1 1 - NONE 6 - BUS - CHARTER/TOUR 11 - FIRE 16 - FARM 21 - MAIL CARRIER

2 - TAXI 7 - BUS - INTERCITY 12 - MILITARY 17 - MOWING 99 - OTHER / UNKNOWN

3 - ELECTRONIC RIDE SHARING 8 - BUS - SHUTTLE 13 - POLICE 18 - SNOW REMOVAL

4 - SCHOOL TRANSPORT 9 - BUS - OTHER 14 - PUBLIC UTILITY 19 - TOWING

5 - BUS - TRANSIT/COMMUTER 10 - AMBULANCE 15 - CONSTRUCTION EQUIPMENT 20 - SAFETY SERVICE PATROL

CARGO BODY TYPE

0, 1 1 - NO CARGO BODY TYPE / NOT APPLICABLE 3 - VEHICLE TOWING ANOTHER MOTOR VEHICLE 5 - INTERMODAL CONTAINER CHASSIS 8 - POLE 12 - CONCRETE MIXER

2 - BUS 4 - LOGGING 6 - CARGO VAN/ENCLOSED BOX 9 - CARGO TANK 13 - AUTO TRANSPORTER

7 - GRAIN/CHIPS/GRAVEL 11 - DUMP 10 - FLAT BED 14 - GARBAGE/REFUSE 99 - OTHER / UNKNOWN

VEHICLE DEFECTS

1 - TURN SIGNALS 4 - BRAKES 7 - WORN OR SLICK TIRES 9 - MOTOR TROUBLE 99 - OTHER / UNKNOWN

2 - HEAD LAMPS 5 - STEERING 8 - TRAILER EQUIPMENT DEFECTIVE 10 - DISABLED FROM PRIOR ACCIDENT

3 - TAIL LAMPS 6 - TIRE BLOWOUT

NON-MOTORIST LOCATION AT IMPACT

1 - INTERSECTION - MARKED CROSSWALK 3 - INTERSECTION - OTHER 6 - BICYCLE LANE 9 - MEDIA CROSSING ISLAND 12 - FIRST RESPONDER AT INCIDENT SCENE

2 - INTERSECTION - UNMARKED CROSSWALK 4 - MIDDLEBLOCK - MARKED CROSSWALK 7 - SHOULDER / ROADSIDE 10 - DRIVEWAY ACCESS 99 - OTHER / UNKNOWN

5 - TRAVEL LANE - OTHER LOCATION 8 - SIDEWALK 11 - SHARED USE PATHS OR TRAILS

ACTION

4 1 - NON-CONTACT 1 - STRAIGHT AHEAD 7 - MAKING U-TURN 13 - NEGOTIATING A CURVE 18 - APPROACHING OR LEAVING VEHICLE OR LEAVING LOCATION 19 - STANDING

0, 1 2 - NON-COLLISION 2 - BACKING 8 - ENTERING TRAFFIC LANE 14 - ENTERING OR CROSSING SPECIFIED LOCATION 20 - OTHER NON-MOTORIST

3 - STRIKING 3 - CHANGING LANES 9 - LEAVING TRAFFIC LANE 15 - WALKING, RUNNING, JOGGING, PLAYING 21 - STANDING OUTSIDE DISABLED VEHICLE

4 - STRUCK PRE-CRASH ACTIONS 4 - OVERTAKING/PASSING 10 - PARKED 16 - WORKING 17 - PUSHING VEHICLE 99 - OTHER / UNKNOWN

5 - BOTH STRIKING & STRUCK 5 - MAKING RIGHT TURN 11 - SLOWING OR STOPPED IN TRAFFIC 12 - DRIVERLESS

9 - OTHER / UNKNOWN 6 - MAKING LEFT TURN

CONTRIBUTING CIRCUMSTANCES

0, 1 1 - NONE 7 - LEFT OF CENTER 13 - IMPROPER START FROM A PARKED POSITION 17 - VISION OBSTRUCTION 21 - LYING IN ROADWAY

2 - FAILURE TO YIELD 8 - FOLLOWING TOO CLOSE / ACD 14 - STOPPED OR PARKED ILLEGALLY 18 - OPERATING DEFECTIVE EQUIPMENT 22 - NOT DISCERNIBLE

3 - RAN RED LIGHT 9 - IMPROPER LANE CHANGE 15 - SWERVING TO AVOID 19 - LOAD SHIFTING/FALLING/ SPILLING 23 - OPENING DOOR INTO ROADWAY

4 - RAN STOP SIGN 10 - IMPROPER PASSING 16 - WRONG WAY 20 - IMPROPER CROSSING 99 - OTHER IMPROPER ACTION

5 - UNSAFE SPEED 11 - DROVE OFF ROAD 12 - IMPROPER BACKING

6 - IMPROPER TURN

SEQUENCE OF EVENTS

1 1, 9 1 - OVERTURN/ROLLOVER 6 - EQUIPMENT FAILURE 11 - CROSS CENTERLINE - OPPOSITE DIRECTION OF TRAVEL 16 - RAILWAY VEHICLE 22 - WORK ZONE MAINTENANCE EQUIPMENT

2 1 2 - FIRE/EXP. OSION 7 - SEPARATION OF UNITS 12 - DOWNHILL RUNAWAY 17 - ANIMAL - FARM 23 - STRUCK BY FALLING, SHIFTING CARGO OR ANYTHING SET IN MOTION BY A MOTOR VEHICLE

3 1 3 - IMMERSION 8 - RAN OFF ROAD RIGHT 13 - OTHER NON-COLLISION 18 - ANIMAL - DEER 24 - OTHER MOVABLE OBJECT

4 1 4 - JACKKNIFE 9 - RAN OFF ROAD LEFT 14 - PEDESTRIAN 19 - ANIMAL - OTHER 20 - MOTOR VEHICLE IN TRANSPORT

5 1 5 - CARGO / EQUIPMENT LOSS OR SHIFT 10 - CROSS MEDIAN 15 - PEDAL CYCLE 21 - PARKED MOTOR VEHICLE

COLLISION WITH FIXED OBJECT - STRUCK

25 - IMPACT ATTENUATOR / CRASH CUSHION 31 - GUARDRAIL END 37 - TRAFFIC SIGN POST 43 - CURB 50 - WORK ZONE MAINTENANCE EQUIPMENT

26 - BRIDGE OVERHEAD STRUCTURE 32 - PORTABLE BARRIER 38 - OVERHEAD SIGN POST 44 - DITCH 51 - WALL

27 - BRIDGE PIER OR ABUTMENT 33 - MEDIAN CABLE BARRIER 39 - LIGHT / LUMINARIES SUPPORT 45 - EMBANKMENT 52 - BUILDING

28 - BRIDGE PARAPET 34 - MEDIAN GUARDRAIL BARRIER 40 - UTILITY POLE 46 - FENCE 53 - TUNNEL

29 - BRIDGE RAIL 35 - MEDIAN CONCRETE BARRIER 41 - OTHER POST, POLE OR SUPPORT 47 - MAILBOX 54 - OTHER FIXED OBJECT

30 - GUARDRAIL FACE 36 - MEDIAN OTHER BARRIER 42 - CULVERT 48 - TREE 99 - OTHER / UNKNOWN

49 - FIRE HYDRANT

FIRST HARMFUL EVENT 1 **MOST HARMFUL EVENT** 1

LOCAL REPORT NUMBER 2020-00020942

DAMAGE

DAMAGE SCALE

2 1 - NONE 3 - FUNCTIONAL DAMAGE

2 - MINOR DAMAGE 4 - DISABLING DAMAGE

9 - UNKNOWN

DAMAGED AREA(S)

INDICATE ALL THAT APPLY

NO DAMAGE [0] UNDERCARRIAGE [14]

TOP [13] ALL AREAS [15]

UNIT NOT AT SCENE [16]

INITIAL POINT OF CONTACT

0, 9 0 - NO DAMAGE 14 - UNDERCARRIAGE

1-12 - REFER TO UNIT DIAGRAM 15 - VEHICLE NOT AT SCENE

99 - UNKNOWN

TRAFFIC

TRAFFICWAY FLOW

2 1 - ONE-WAY 2 - TWO-WAY

TRAFFIC CONTROL

6 1 - ROUNDABOUT 4 - STOP SIGN 2 - SIGNAL 5 - YIELD SIGN 3 - FLASHER 6 - NO CONTROL

of THROUGH LANES ON ROAD

2

RAIL GRADE CROSSING

1 1 - NOT INVOLVED 2 - INVOLVED-ACTIVE CROSSING 3 - INVOLVED-PASSIVE CROSSING

UNIT / NON-MOTORIST DIRECTION

FROM 3 TO 4

1 - NORTH 5 - NORTH-EAST 2 - SOUTH 6 - NORTHWEST 3 - EAST 7 - SOUTHEAST 4 - WEST 8 - SOUTHWEST 9 - OTHER / UNKNOWN

UNIT SPEED

0, 3, 5

DETECTED SPEED

1 1 - STATED / ESTIMATED SPEED 2 - CALCULATED / EDR 3 - UNDETERMINED

POSTED SPEED

3, 5



MOTORIST / Non-MOTORIST

LOCAL REPORT NUMBER
2 0 2 0 - 0 0 0 2 0 9 4 2

UNIT # 0 1	NAME: LAST, FIRST, MIDDLE NICHOLLS, KATHRYN, MARIE	DATE OF BIRTH 0 9 0 1 1 9 6 3	AGE 5 7	GENDER F
----------------------	--	---	-------------------	--------------------

ADDRESS: STREET, CITY, STATE, ZIP
4011 DAWLEY RD ,Ravenna Twp ,OH 44266

CONTACT PHONE - INCLUDE AREA CODE

INJURIES 5	INJURED TAKEN BY	EMS AGENCY (NAME)	INJURED TAKEN TO: MEDICAL FACILITY (NAME, CITY)	SAFETY EQUIPMENT USED 0 4	<input type="checkbox"/> DOT-COMPLIANT MC HELMET	SEATING POSITION 0 1	AIR BAG USAGE 1	EJECTION 1	TRAPPED 1
----------------------	------------------	-------------------	---	-------------------------------------	--	--------------------------------	---------------------------	----------------------	---------------------

OL STATE O, H	OPERATOR LICENSE NUMBER	OFFENSE CHARGED	LOCAL CODE <input type="checkbox"/>	OFFENSE DESCRIPTION	CITATION NUMBER
-------------------------	-------------------------	-----------------	--	---------------------	-----------------

OL CLASS 4	ENDORSEMENT SELECT UP TO 2	RESTRICTION SELECT UP TO 3	DRIVER DISTRACTED BY 1	ALCOHOL / DRUG SUSPECTED <input type="checkbox"/> ALCOHOL <input type="checkbox"/> MARIJUANA <input type="checkbox"/> OTHER DRUG	CONDITION 1	ALCOHOL TEST STATUS TYPE VALUE 1 1			DRUG TEST(S) STATUS TYPE RESULT SELECT UP TO 4 1 1		
----------------------	----------------------------	----------------------------	----------------------------------	--	-----------------------	---	--	--	---	--	--

UNIT #	NAME: LAST, FIRST, MIDDLE	DATE OF BIRTH	AGE	GENDER
--------	---------------------------	---------------	-----	--------

ADDRESS: STREET, CITY, STATE, ZIP

CONTACT PHONE - INCLUDE AREA CODE

INJURIES	INJURED TAKEN BY	EMS AGENCY (NAME)	INJURED TAKEN TO: MEDICAL FACILITY (NAME, CITY)	SAFETY EQUIPMENT USED	<input type="checkbox"/> DOT-COMPLIANT MC HELMET	SEATING POSITION	AIR BAG USAGE	EJECTION	TRAPPED
----------	------------------	-------------------	---	-----------------------	--	------------------	---------------	----------	---------

OL STATE	OPERATOR LICENSE NUMBER	OFFENSE CHARGED	LOCAL CODE <input type="checkbox"/>	OFFENSE DESCRIPTION	CITATION NUMBER
----------	-------------------------	-----------------	--	---------------------	-----------------

OL CLASS	ENDORSEMENT SELECT UP TO 2	RESTRICTION SELECT UP TO 3	DRIVER DISTRACTED BY	ALCOHOL / DRUG SUSPECTED <input type="checkbox"/> ALCOHOL <input type="checkbox"/> MARIJUANA <input type="checkbox"/> OTHER DRUG	CONDITION	ALCOHOL TEST STATUS TYPE VALUE			DRUG TEST(S) STATUS TYPE RESULT SELECT UP TO 4		
----------	----------------------------	----------------------------	----------------------	--	-----------	-----------------------------------	--	--	---	--	--

UNIT #	NAME: LAST, FIRST, MIDDLE	DATE OF BIRTH	AGE	GENDER
--------	---------------------------	---------------	-----	--------

ADDRESS: STREET, CITY, STATE, ZIP

CONTACT PHONE - INCLUDE AREA CODE

INJURIES	INJURED TAKEN BY	EMS AGENCY (NAME)	INJURED TAKEN TO: MEDICAL FACILITY (NAME, CITY)	SAFETY EQUIPMENT USED	<input type="checkbox"/> DOT-COMPLIANT MC HELMET	SEATING POSITION	AIR BAG USAGE	EJECTION	TRAPPED
----------	------------------	-------------------	---	-----------------------	--	------------------	---------------	----------	---------

OL STATE	OPERATOR LICENSE NUMBER	OFFENSE CHARGED	LOCAL CODE <input type="checkbox"/>	OFFENSE DESCRIPTION	CITATION NUMBER
----------	-------------------------	-----------------	--	---------------------	-----------------

OL CLASS	ENDORSEMENT SELECT UP TO 2	RESTRICTION SELECT UP TO 3	DRIVER DISTRACTED BY	ALCOHOL / DRUG SUSPECTED <input type="checkbox"/> ALCOHOL <input type="checkbox"/> MARIJUANA <input type="checkbox"/> OTHER DRUG	CONDITION	ALCOHOL TEST STATUS TYPE VALUE			DRUG TEST(S) STATUS TYPE RESULT SELECT UP TO 4		
----------	----------------------------	----------------------------	----------------------	--	-----------	-----------------------------------	--	--	---	--	--

INJURIES	SEATING POSITION	AIR BAG	OL CLASS	OL RESTRICTION(S)	DRIVER DISTRACTION	TEST STATUS
1- FATAL 2- SUSPECTED SERIOUS INJURY 3- SUSPECTED MINOR INJURY 4- POSSIBLE INJURY 5- NO APPARENT INJURY	1- FRONT - LEFT SIDE (MOTORCYCLE DRIVER) 2- FRONT - MIDDLE 3- FRONT - RIGHT SIDE 4- SECOND - LEFT SIDE (MOTORCYCLE PASSENGER) 5- SECOND - MIDDLE 6- SECOND - RIGHT SIDE 7- THIRD - LEFT SIDE (MOTORCYCLE SIDE CAR) 8- THIRD - MIDDLE 9- THIRD - RIGHT SIDE 10- SLEEPER SECTION OF TRUCK CAB	1- NOT DEPLOYED 2- DEPLOYED FRONT 3- DEPLOYED SIDE 4- DEPLOYED BOTH FRONT / SIDE 5- NOT APPLICABLE 9- DEPLOYMENT UNKNOWN	1- CLASS A 2- CLASS B 3- CLASS C 4- REGULAR CLASS (OHIO = D) 5- MC HOPED ONLY 6- NO VALID OL	1- ALCOHOL INTERLOCK DEVICE 2- CDL INTRASTATE ONLY 3- CORRECTIVE LENSES 4- FARM WAIVER 5- EXCEPT CLASS A BUS 6- EXCEPT CLASS A & CLASS B BUS 7- EXCEPT TRACTOR TRAILER 8- INTERMEDIATE LICENSE RESTRICTIONS 9- LEARNER'S PERMIT RESTRICTIONS 10- LIMITED TO DAYLIGHT ONLY 11- LIMITED TO EMPLOYMENT 12- LIMITED - OTHER 13- MECHANICAL DEVICES (SPECIAL BRAKES, HAND CONTROLS, OR OTHER ADAPTIVE DEVICES) 14- MILITARY VEHICLES ONLY 15- MOTOR VEHICLES WITHOUT AIR BRAKES 16- OUTSIDE MIRROR 17- PROSTHETIC AID 18- OTHER	1- NOT DISTRACTED 2- MANUALLY OPERATING AN ELECTRONIC COMMUNICATION DEVICE (TEXTING, TYPING, DIALING) 3- TALKING ON HANDS-FREE COMMUNICATION DEVICE 4- TALKING ON HAND-HELD COMMUNICATION DEVICE 5- OTHER ACTIVITY WITH AN ELECTRONIC DEVICE 6- PASSENGER 7- OTHER DISTRACTION INSIDE THE VEHICLE 8- OTHER DISTRACTION OUTSIDE THE VEHICLE 9- OTHER / UNKNOWN	1- NONE GIVEN 2- TEST REFUSED 3- TEST GIVEN, CONTAMINATED SAMPLE / UNUSABLE 4- TEST GIVEN, RESULTS KNOWN 5- TEST GIVEN, RESULTS UNKNOWN
INJURED TAKEN BY	EJECTION	TRAPPED	OL ENDORSEMENT	CONDITION	ALCOHOL TEST TYPE	DRUG TEST TYPE
1- NOT TRANSPORTED / TREATED AT SCENE 2- EMS 3- POLICE 9- OTHER / UNKNOWN	1- NOT EJECTED 2- PARTIALLY EJECTED 3- TOTALLY EJECTED 4- NOT APPLICABLE	1- NOT TRAPPED 2- EXTRICATED BY MECHANICAL MEANS 3- FREED BY NON-MECHANICAL MEANS	H - HAZMAT M - MOTORCYCLE P - PASSENGER N - TANKER Q - MOTOR SCOOTER R - THREE WHEEL MOTORCYCLE S - SCHOOL BUS T - DOUBLE & TRIPLE TRAILERS X - TANKER / HAZMAT	1- APPARENTLY NORMAL 2- PHYSICAL IMPAIRMENT 3- EMOTIONAL (E.G. DEPRESSED, ANGER, DISTRESS) 4- ILLNESS 5- FELL ASLEEP, FAINTED, FATIGUED, ETC. 6- UNDER THE INFLUENCE OF MEDICATIONS / DRUGS / ALCOHOL 9- OTHER - UNKNOWN	1- NONE 2- BLOOD 3- URINE 4- BREATH 5- OTHER	1- NONE 2- BLOOD 3- URINE 4- OTHER
SAFETY EQUIPMENT	TRAPPED	TRAPPED	GENDER	CONDITION	DRUG TEST RESULT(S)	DRUG TEST RESULT(S)
1- NONE USED 2- SHOULDER BELT ONLY USED 3- LAP BELT ONLY USED 4- SHOULDER & LAP BELT USED 5- CHILD RESTRAINT SYSTEM - FORWARD FACING 6- CHILD RESTRAINT SYSTEM - REAR FACING 7- BOOSTER SEAT 8- HELMET USED 9- PROTECTIVE PADS USED (ELBOW, KNEES, ETC.) 10- REFLECTIVE CLOTHING 11- LIGHTING - PEDESTRIAN / BICYCLE ONLY 99- OTHER / UNKNOWN	1- NOT TRAPPED 2- EXTRICATED BY MECHANICAL MEANS 3- FREED BY NON-MECHANICAL MEANS	1- NOT TRAPPED 2- EXTRICATED BY MECHANICAL MEANS 3- FREED BY NON-MECHANICAL MEANS	F - FEMALE M - MALE U - OTHER / UNKNOWN	1- APPARENTLY NORMAL 2- PHYSICAL IMPAIRMENT 3- EMOTIONAL (E.G. DEPRESSED, ANGER, DISTRESS) 4- ILLNESS 5- FELL ASLEEP, FAINTED, FATIGUED, ETC. 6- UNDER THE INFLUENCE OF MEDICATIONS / DRUGS / ALCOHOL 9- OTHER - UNKNOWN	1- NONE 2- BLOOD 3- URINE 4- OTHER	1- AMPHETAMINES 2- BARBITURATES 3- BENZODIAZEPINES 4- CANNABINOIDS 5- COCAINE 6- OPIATES / OPIOIDS 7- OTHER 8- NEGATIVE RESULTS

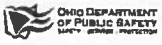

OCCUPANT / WITNESS ADDENDUM

LOCAL REPORT NUMBER
2 0 2 0 - 0 0 0 2 0 9 4 2

UNIT # NAME: LAST, FIRST, MIDDLE
01 NICHOLLS, MEGAN, MARIE

DATE OF BIRTH AGE GENDER
0 8 0 7 1 9 9 4 2 6 F

ADDRESS: STREET, CITY, STATE, ZIP
4011 DAWLEY RD ,Ravenna Twp ,OH 44266

CONTACT PHONE - INCLUDE AREA CODE

INJURIES INJURED TAKEN BY EMS AGENCY (NAME) INJURED TAKEN TO: MEDICAL FACILITY (NAME, CITY) SAFETY EQUIPMENT USED
5

DOT-COMPLIANT MC HELMET SEATING POSITION AIR BAG USAGE EJECTION TRAPPED
0 3 1 1 1

UNIT # NAME: LAST, FIRST, MIDDLE

DATE OF BIRTH AGE GENDER

ADDRESS: STREET, CITY, STATE, ZIP

CONTACT PHONE - INCLUDE AREA CODE

INJURIES INJURED TAKEN BY EMS AGENCY (NAME) INJURED TAKEN TO: MEDICAL FACILITY (NAME, CITY) SAFETY EQUIPMENT USED

DOT-COMPLIANT MC HELMET SEATING POSITION AIR BAG USAGE EJECTION TRAPPED

UNIT # NAME: LAST, FIRST, MIDDLE

DATE OF BIRTH AGE GENDER

ADDRESS: STREET, CITY, STATE, ZIP

CONTACT PHONE - INCLUDE AREA CODE

INJURIES INJURED TAKEN BY EMS AGENCY (NAME) INJURED TAKEN TO: MEDICAL FACILITY (NAME, CITY) SAFETY EQUIPMENT USED

DOT-COMPLIANT MC HELMET SEATING POSITION AIR BAG USAGE EJECTION TRAPPED

UNIT # NAME: LAST, FIRST, MIDDLE

DATE OF BIRTH AGE GENDER

ADDRESS: STREET, CITY, STATE, ZIP

CONTACT PHONE - INCLUDE AREA CODE

INJURIES INJURED TAKEN BY EMS AGENCY (NAME) INJURED TAKEN TO: MEDICAL FACILITY (NAME, CITY) SAFETY EQUIPMENT USED

DOT-COMPLIANT MC HELMET SEATING POSITION AIR BAG USAGE EJECTION TRAPPED

INJURIES	SAFETY EQUIPMENT USED	SEATING POSITION	AIR BAG USAGE
1 - FATAL	1 - NONE USED - VEHICLE OCCUPANT	1 - FRONT - LEFT SIDE (MOTORCYCLE DRIVER)	1 - NOT DEPLOYED
2 - SUSPECTED SERIOUS INJURY	2 - SHOULDER BELT ONLY USED	2 - FRONT - MIDDLE	2 - DEPLOYED FRONT
3 - SUSPECTED MINOR INJURY	3 - LAP BELT ONLY USED	3 - FRONT - RIGHT SIDE	3 - DEPLOYED SIDE
4 - POSSIBLE INJURY	4 - SHOULDER & LAP BELT USED	4 - SECOND - LEFT SIDE (MOTORCYCLE PASSENGER)	4 - DEPLOYED BOTH FRONT/SIDE
5 - NO APPARENT INJURY	5 - CHILD RESTRAINT SYSTEM - FORWARD FACING	5 - SECOND - MIDDLE	5 - NOT APPLICABLE
	6 - CHILD RESTRAINT SYSTEM - REAR FACING	6 - SECOND - RIGHT SIDE	9 - DEPLOYMENT UNKNOWN
	7 - BOOSTER SEAT	7 - THIRD - LEFT SIDE (MOTORCYCLE SIDE CAR)	
	8 - HELMET USED	8 - THIRD - MIDDLE	
	9 - PROTECTIVE PADS USED (ELBOW, KNEES, ETC.)	9 - THIRD - RIGHT SIDE	
	10 - REFLECTIVE CLOTHING	10 - SLEEPER SECTION OF TRUCK CAB	
	11 - LIGHTING - PEDESTRIAN / BICYCLE ONLY	11 - PASSENGER IN OTHER ENCLOSED CARGO AREA (NON-TRAILING UNIT, BUS, PICK UP WITH CAP)	
	99 - OTHER / UNKNOWN	12 - PASSENGER IN UNENCLOSED CARGO AREA	
		13 - TRAILING UNIT	
		14 - RIDING ON VEHICLE EXTERIOR (NON-TRAILING UNIT)	
		15 - NON-MOTORIST	
		99 - OTHER / UNKNOWN	

NAME: LAST, FIRST, MIDDLE

DATE OF BIRTH AGE GENDER

ADDRESS: STREET, CITY, STATE, ZIP

CONTACT PHONE - INCLUDE AREA CODE

NAME: LAST, FIRST, MIDDLE

DATE OF BIRTH AGE GENDER

ADDRESS: STREET, CITY, STATE, ZIP

CONTACT PHONE - INCLUDE AREA CODE

NAME: LAST, FIRST, MIDDLE

DATE OF BIRTH AGE GENDER

ADDRESS: STREET, CITY, STATE, ZIP

CONTACT PHONE - INCLUDE AREA CODE